

Series Spec Sheet

PRMS

STEEL COMBO

NBC2015 compliant

The PRMS series of commercial combination steel signs and battery units features a slim profile that eliminates light leaks combined with a simple, easy to install design. Two PAR18 small style, front mounted heads are standard, MR16 type is optional.

FEATURES AND SPECIFICATIONS

• Electrical circuitry

- LED ultra bright light source
- 120/347 VAC Input, field selectable, or 277 VAC
- 1.8 W power consumption for LED exit portion of combination sign
- LED Emergency DC wattages as follows:
6 VDC = 0.9 W, 12 VDC = 0.86 W
- 6 VDC or 12 VDC emergency power output versions (as specified)
- Wattage capacities from 36 to 72 W
- 30 minutes emergency power duration standard
- Momentary push button test switch
- Pilot LEDs for AC, ON and CHARGE
- Fully automatic, current limited charger
- Solid state design and construction
- Brownout and short circuit protection
- Temperature compensated
- Maintenance free, sealed lead acid battery

• Mechanical

- 20 Gauge steel construction
- Slide out faceplates and backplates for rapid and simple installation
- Universal spider knockout pattern stamped into backplate for junction box mounting
- Universal models include ceiling or end mount, field installable canopy kit c/w spider plate
- Multiple conduit entry knockouts
- White powder coat finish standard
- PAR18 small style, high impact thermoplastic heads are standard (2N)
- Optional heads include die cast metal MR16 type
- Front head mounting is standard, side mount is optional

• Approvals

- CSA Certified to C22.2 #141-15
- CSA Certified to C860-11

• Compliance

- Meets requirements of ICES-005



OVERVIEW

Light source	LED
Input voltage (VCA)	120/347, 277
Sign Power consumption	120 V = 1.80 W 347 V = 1.70 W 277 V = 1.40 W
Sign Emergency Power consumption	6 VDC = 0.9 W 12 VDC = 0.86 W
Output capacity (W)	36 - 72



quick
ship



LED
fixture



ICES
005



link
compatible



Energy Verified
Energie Vérifiée

QUICK SHIP AND TECHNICAL SPECIFICATION TABLE ¹

Part number	DC Volts (VDC)	Watts (W)	Nbr of faces	Nbr of heads	Head	Lamp (W)	Light source	Input Volts (VAC)	Color
PRMS60360-2N09T	6	36	Universal	2	N	9	Tungsten	120/347	White

¹ **QUICK SHIP:** Product availability is subject to change without notice. Please contact your Stanpro customer service representative to confirm inventory levels at time of order.

ORDERING GUIDE

Series	Volts (V)	Watts (W)	Nbr of faces	Nbr of heads	Head / Lamp	Lamp	Input voltage (V)	Colors	Options
PRMS	6 - 6	036 - 36 050 - 50	0 - Universal faces 1 - Single face	00 - No heads	Blank - No heads	See lamp selection chart below	Blank - 120/347 E - 277	WH - White BK - Black GY - Grey	AT, AUD ¹ , AUE, BO, OP, TP, PGD, WGD ² , WO
	1 - 12	036 - 36 050 - 50 072 - 72	2 - Double face	1 - One heads 2 - Two heads	N - PAR18 (standard) S - MR16 M - MR16				0 - No indicators (double face only)  Note: Indicators option available for single & double option only.

¹ Only available with AT.

² Specify mounting.

EMERGENCY LIGHTING OPTIONS

Option	Description
AT	Automatic test and self-diagnostic
AUD	Audible Diagnostic ¹
AUE	Audible Emergency
BO	Black Out Option
OP	Special Wording
TP	Tamper Proof Screws
PGD	Lexan Guard (separate order)
WGD	Wireguard (separate order)
WO	White Out Option

¹ Only available with AT.

LAMP SELECTION

	6 V	12 V
PAR18 • Small head or LED Lamp		
LED	3LJ, 4LJ, 5LJ	3LJ, 4LJ, 5LJ, 6LA, 7LA
Quartz halogen	10Q	10Q, 12Q
Tungsten	09T	09T
MR16 • Small head c/w MR16 or LED Lamp		
LED	4LR, 5LA	4LR, 5LA, 6LA, 7LA
Quartz halogen	10Q	12Q, 20Q, 35Q

MODEL RATINGS

Model	Volts (V)	Wattage capacities (W)			
		30 min.	60 min.	90 min.	120 min.
PRMS6036	6	36	18	12	9
PRMS6050	6	50	25	16	12
PRMS1036	12	36	18	12	9
PRMS1050	12	50	25	16	12
PRMS1072	12	72	36	24	18

Data is based upon tests performed in a controlled environment. Actual performance can vary depending on operating conditions. All products are subject to change or may be discontinued any time without notice.

WIREGUARD¹

		Part number	Dimensions (in)
Without head	Wall mount	WGD590	15.25x14.25x6.75
	Ceiling mount	WGD650	13.75x12.25x16.5
	End mount	WGD650	13.75x12.25x16.5
With head(s)	Wall mount	WGD510	17.25x17.25x7
	Ceiling mount	WGD650	13.75x12.25x16.5
	End mount	WGD650	13.75x12.25x16.5

¹ Please contact your Stanpro customer service representative for more information.

SPACING GUIDE

Mounting height	Spacing center to center (ft)						
	3WLJ	4WLJ	5WLJ	4WLR	5WLA	6WLA	7WLA
8 ft	78	83	118	76	81	94	108
10 ft	75	76	118	79	79	93	106
15 ft	66	68	104	66	62	82	96
20 ft	53	53	91	53	49	73	87

DIMENSIONS

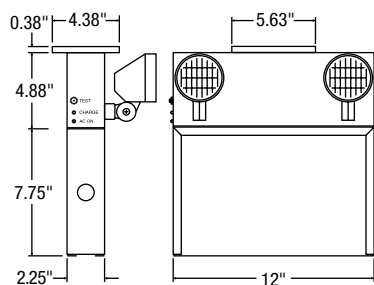

TYPE N - PAR18

Thermoplastic
12 W max.

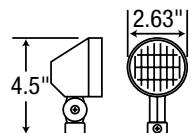

TYPE S - MR16

Die cast
35 W max.

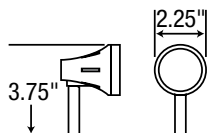

TYPE M - MR16

Die cast
35 W max.

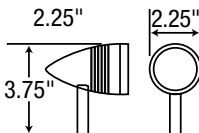

CONFIGURATIONS



Comes standard (single face) with three pictogram legends for direction selection.



Comes standard (double face) with two pictogram legends.



For double face no arrow options, select "0" on the options column.

Data is based upon tests performed in a controlled environment. Actual performance can vary depending on operating conditions. All products are subject to change or may be discontinued any time without notice.