

HOW TO REPLACE WINDOW HANDLES

MEASURING AND IDENTIFYING THE RIGHT REPLACEMENT

WITH IDEAL SECURITY'S SK925, SK927, SK928, OR SK929T

1. REMOVE THE OLD WINDOW HANDLE

IF THERE IS NO SET SCREW



Insert a flat screw driver between the housing and the handle, gently pry off the window handle

IF THERE IS A SET SCREW



Use a phillips screw driver to loosen the set screw and pull off the window handle.

2. MEASURE THE "WINDOW OPERATOR"

THE WINDOW OPERATOR GEAR SHOULD BE 5/16" IN DIAMETER, AND HAVE 12 TEETH.
IF NOT, OUR HANDLES WON'T FIT.

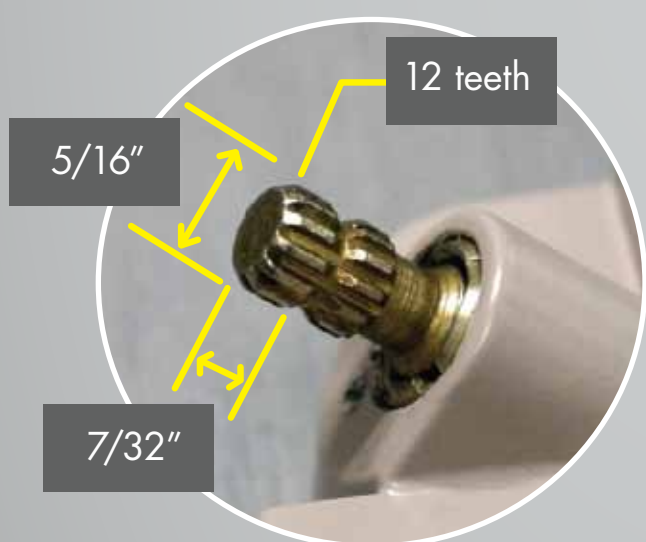

3. CHOOSE THE RIGHT HANDLE

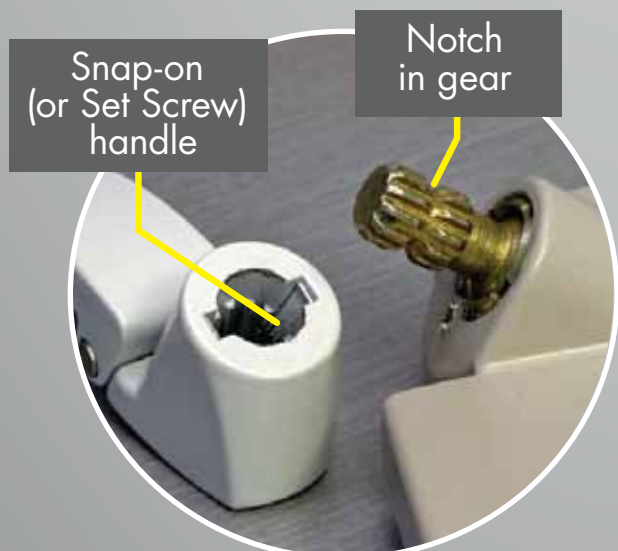

For this type of operator, use:
SK925, SK927, SK928 or SK929T



For this type of operator, use:
SK925 or SK929T

4. INSTALL YOUR NEW HANDLES

FOLLOW THE INSTRUCTIONS THAT COME WITH THE HANDLES

FOR MORE INFORMATION VISIT: www.idealinc.com