

# Installation Instructions

## LED CEILING DOUBLE RING LUMINAIRE



### IMPORTANT – READ ALL INSTRUCTIONS BEFORE INSTALLATION

- Installation and maintenance must be performed by licensed electricians only.
- To avoid risk of electric shock, make sure to turn off main power switch prior to installation or maintenance.
- Must be installed in compliance with National Electrical Code (NEC) in the US or Canadian Electrical Code in Canada.
- Ensure input voltage and frequency is compatible with the fixture. Check product manual for power requirements prior to installation.

### WARNING: RISK OF ELECTRIC SHOCK. SUITABLE FOR DAMP LOCATIONS.

- Must be grounded.
- Minimum 90 °C supply conductors
- Surface-mounted
- This product must be installed in accordance with the applicable installation code by a person familiar with the construction and operation of the product and the hazards involved.

### ELECTRICAL COMPONENTS AND CHARACTERISTICS

- Universal AC input voltage (120 V)
- Nominal power factor: 0.9
- Dimming: Yes

### INCLUDED ACCESSORIES

- A. Wire Connectors (3)
- B. Mounting Screws (2)



### MOUNTING INSTRUCTIONS: TURN OFF POWER BEFORE INSTALLATION

1. Before beginning assembly, installation or operation of product, make sure all parts are present.
2. Turn off the power before installation. (Fig. 1)
3. Unscrew the 3 nuts to remove the lens from the back plate. (Fig. 2)
4. Insert the screws (B) into the junction box, leaving space to insert the luminaire, with 2/3 inside and 1/3 outside (Fig. 3).
5. Make the electrical connection. Connect the black and white wires of the luminaire to the two wires of the same color from the junction box using wire connectors (A). Connect the ground wire of the luminaire to the ground wire from the junction box (Fig. 4).
6. Place the luminaire plate across the screw of the lock, then rotate the luminaire plate counterclockwise and lock it tightly using the screw lock. (Fig. 5)
7. Secure the luminaire by tightening the mounting screws. (Fig. 6)
8. Mount the diffuser and twist it into place using the cover ring and secure it using the 3 nuts includes. (Fig. 7)
9. Turn on power and turn on the light switch to activate the luminaire. (Fig. 8)

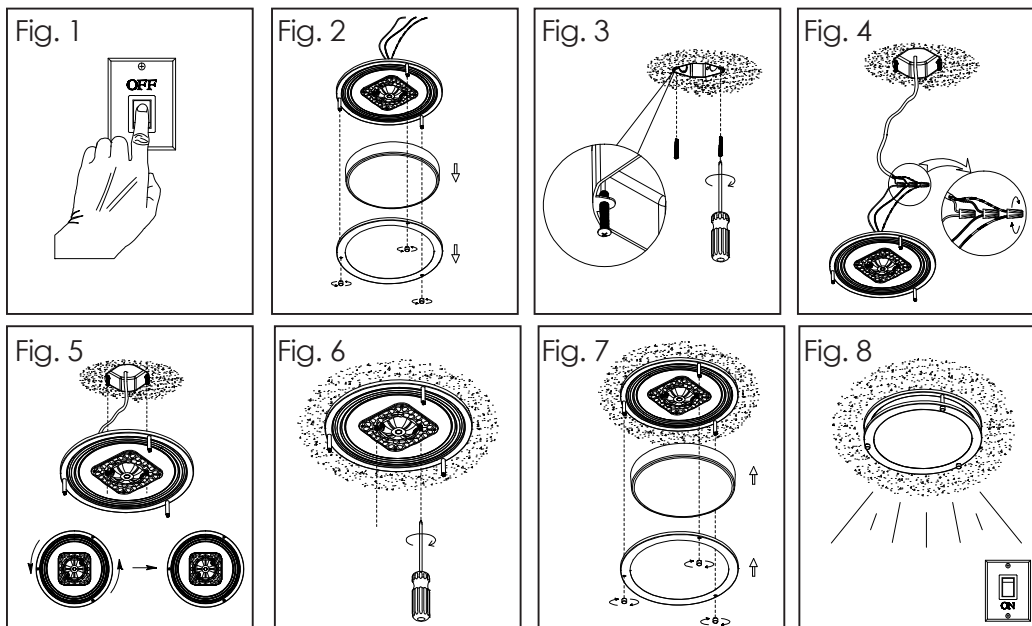

### MAINTENANCE:

1. Clean and maintain the luminaire regularly.
2. When cleaning, use a soft cloth with non-abrasive detergent and wipe dry with a clean soft cloth.
3. Do not use any cleaners that contain alcohol, harsh chemicals or pesticides.
4. When cleaning inside the luminaire, turn off the power, and do not spray liquid cleaner directly on the LEDs, LED driver or wiring.