

LED TRI PROOF LUMINAIRES INSTALLATION INSTRUCTIONS



IMPORTANT - READ ALL INSTRUCTIONS BEFORE INSTALLATION

WARNING: Risk of fire or electric shock. The installation should be performed only by a qualified electrician in accordance with the National Electrical Code and relevant local codes. This product must be installed in full accordance with applicable electrical and building codes.

TO PREVENT ELECTRICAL SHOCK, MAKE SURE TO TURN OFF MAIN POWER SWITCH PRIOR TO THE INSTALLATION.

INSTALLATION INSTRUCTIONS

- Disconnect all power to the wiring intended to be connected to the luminaire.
- Ensure that the ambient temperatures are within the luminaire's rated limits.
- Check the nameplate's marking for more information.
- Remove and unpack the mounting hardware kit.

CAUTION: THE PRODUCT IS NOT SUITABLE FOR ANY OIL POLLUTION AMBIENT OR RELATED APPLICATIONS.

INCLUDED IN THE BOX:



SOLD SEPARATELY:

Mounting Accessory

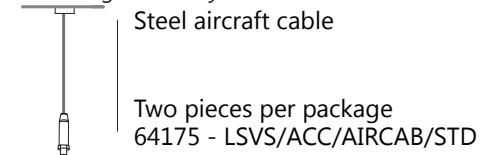

Input voltage	Length	Mount row Max Qty
120 VAC / 20 W	2'	16
240 VAC / 20 W	2'	32
120 VAC / 40 W	4'	8
240 VAC / 40 W	4'	16
347 VAC / 40 W	4'	20

SUSPENDED MOUNT - (64175 - LSVS/ACC/AIRCAB/STD) SOLD SEPARATELY

1. Drill hole for screws (fig.1)
2. Screw the steel cable into the ceiling (fig.2.)
3. Install the lamp into the clip and screw the steel cable into the clips. (fig.3)
4. Cut one extremity of the included linkable cable to make the connection in the junction box. (fig.4) In order to keep your installation IP66 rated, please use an IP66 junction box. Once the first luminaire is connected, use the included linkable cable to row mount next luminaire.

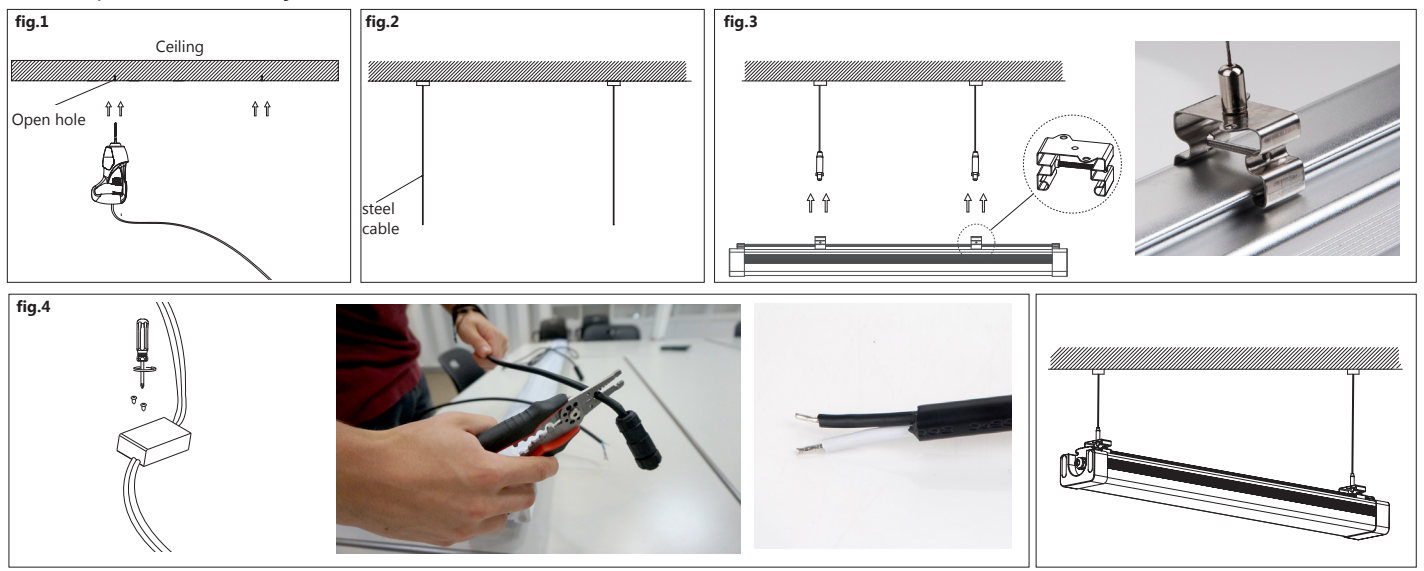

LED TRI PROOF LUMINAIRES INSTALLATION INSTRUCTIONS



SURFACE MOUNT

1. Drill hole for screws (fig.1)
2. Screw the clip into the ceiling tightly (fig2.)
3. Install the lamp into the clips (fig.3)
4. Cut one extremity of the included linkable cable to make the connection in the junction box. (fig.4) In order to keep your installation IP66 rated, please use an IP66 junction box. Once the first luminaire is connected, use the included linkable cable to row mount next luminaire.

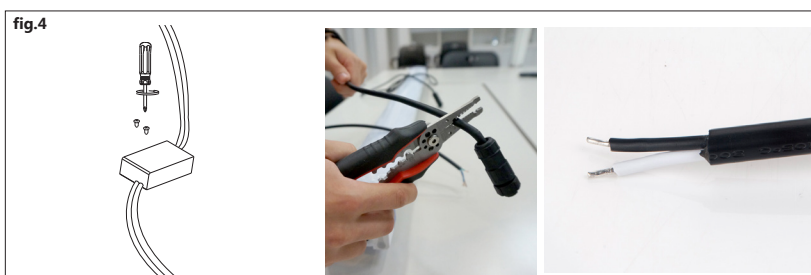
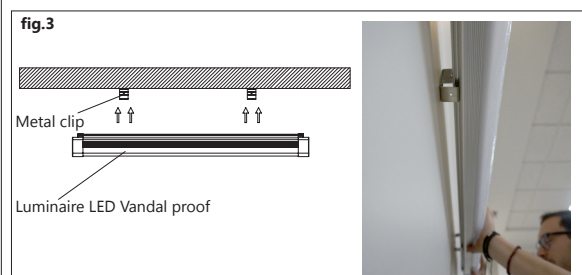
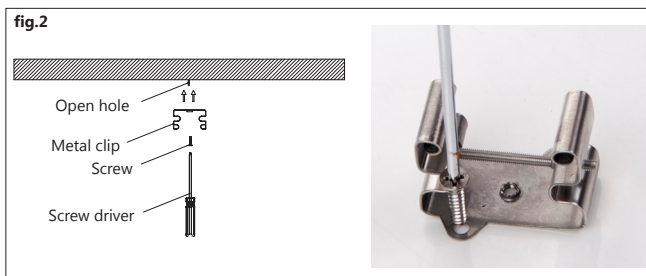
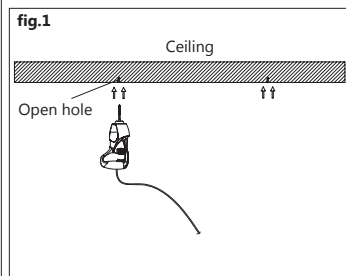

LINKABLE MOUNTING

QTY : 1 (included with each luminaire)

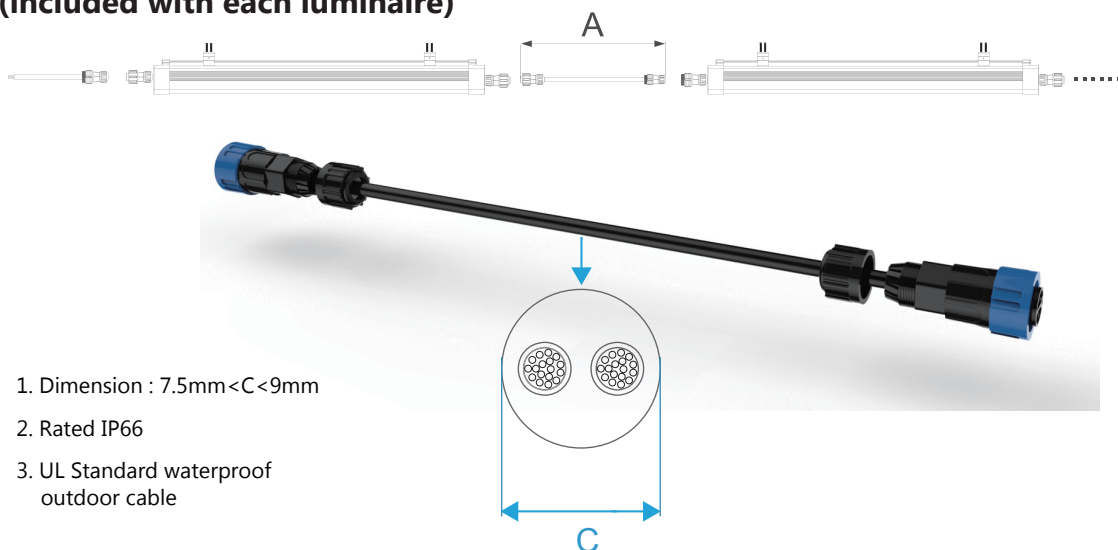

The luminaires are intended for indoor use or under shelter for outdoor use.