

LED CEILING LUMINAIRE - DOUBLE RING INSTALLATION INSTRUCTIONS



IMPORTANT - READ ALL INSTRUCTIONS BEFORE INSTALLATION

- Installation and maintenance must be performed by licensed electricians only.
- To avoid risk of electric shock, make sure to turn off main power switch prior to installation or maintenance.
- Must be installed in compliance with National Electrical Code (NEC) in the US or Canadian Electrical Code in Canada.
- Ensure input voltage and frequency is compatible with the fixture. Check product manual for power requirements prior to installation.

WARNING: Risk of electric shock. Suitable for damp locations.

- Must be grounded
- Minimum 90 °C supply conductors
- Surface mounted
- This product must be installed in accordance with the applicable installation code by a person familiar with the construction and operation of the product and the hazards involved.
- The outlet box should be covered.

ELECTRICAL COMPONENTS AND CHARACTERISTICS

- Integral, high efficiency driver and power supply
- Universal AC input voltage (120 V)
- Nominal power factor: 0.95
- Dimming: Yes

MOUNTING INSTRUCTION: Turn off power before installation.

1. Before beginning assembly, installation or operation of product, make sure all parts are present. Compare pack with package content list.
2. Remove the diffuser from the back plate and install electrical the screws into the junction box, with 2/3 inside and 1/3 inside (see figure 1).
3. Connect the black and white wires of the luminaire with two wires of the same color from the junction box with wire caps. Connect the ground wire of the luminaire with the one from the junction box (see figure 2).
4. Put the luminaire plate across the screw of the lock (seen in figure 3) then rotate luminaire plate clockwise and lock it tightly with the screw lock. Securely mount the fixture plate to the junction box.
5. Mount the diffuser and twist into place using the cover ring and fix it with the 3 nuts includes. (see figure 4)
6. Turn on power and turn on the light switch to activate the luminaire.

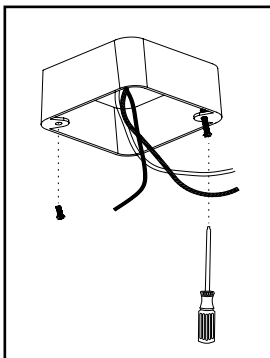

Figure 1

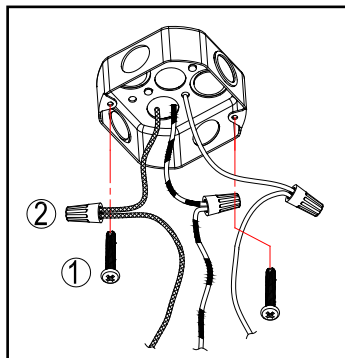

Figure 2

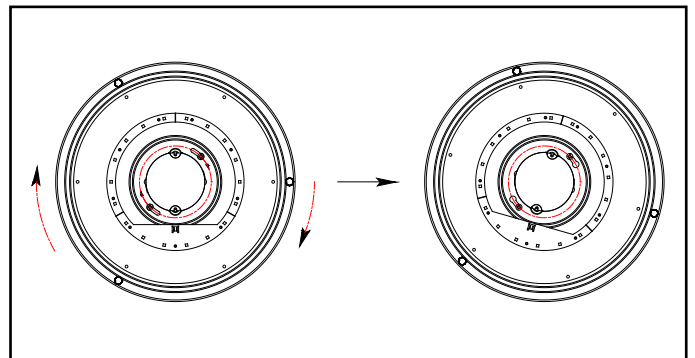

Figure 3

LED CEILING LUMINAIRE - DOUBLE RING INSTALLATION INSTRUCTIONS

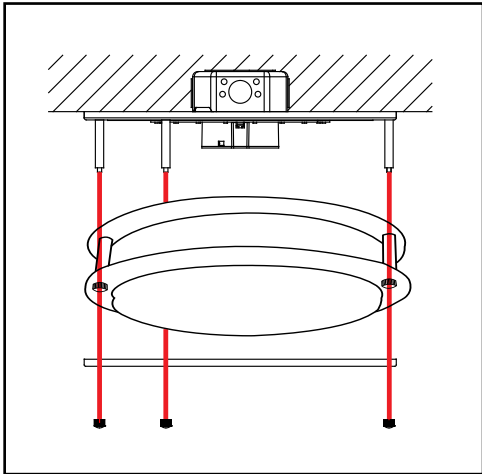

Figure 4

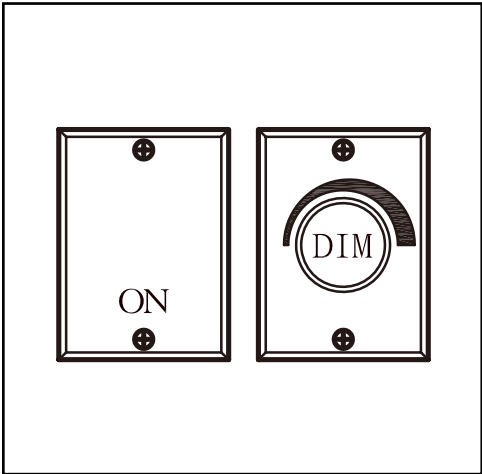

Figure 5

MAINTENANCE

- 1. Clean and maintain the luminaire regularly
- 2. When cleaning, use a soft cloth with non-abrasive detergent and wipe dry with a clean soft cloth
- 3. Do not use any cleaners that contain alcohol, harsh chemicals or pesticides
- 4. When cleaning inside the luminaire, turn off the power, and do not spray liquid cleaner directly on the LEDs, LED driver or wiring.

RECOMMENDED DIMMER

Leviton	6615, IPE04-1LZ
Lutron	DVCL-153P, CTCL-153P, DVCL-253P, AYCL-253P, DVELV-300P, SELV-300P, NTELV-600

Although this product is compatible with most common residential type dimmers, dimming performance varies from dimmer to dimmer. Dimmer settings (for dimmers with brightness range adjustments) and the number of LED modules installed on the circuit can affect dimming performance.