

# Important Instructions

**Subject** Installing Inner Basket Assembly Using Pulley Bolt Tightening Fixture  
**Use With** 803007P, 800428P, 800429P, 800749P, 803008P and 802365P Kits



## WARNING

This kit is to be installed in accordance with the manufacturer's instructions and all codes and requirements of the authority having jurisdiction. In Canada, this conversion/installation shall be carried out in accordance with the requirements of the provincial authorities having jurisdiction and in accordance with the requirements of the CAN/CGA-B149.1 and CAN/CGA-B149.2 installation code. Failure to follow instructions could result in serious injury, death or property damage. The qualified agency performing this work assumes all responsibility for this kit installation.

W013R4

To reduce the risk of electric shock, fire, explosion, serious injury or death:

- Disconnect electric power to the washer before servicing.
- Never start the washer with any guards/panels removed.
- Whenever ground wires are removed during servicing, these ground wires must be reconnected to ensure that the washer is properly grounded.

W003

### Kit No. 803007P consists of:

- 3 - 803017 Nut
- 1 - 803007 Inner Basket
- 1 - 838P3 Hardware Kit
- 3 - 800666 Tension Rod Assembly
- 1 - 802336 Pulley Bolt Tightening Fixture
- 1 - 12-03-183R4 Instructions
- 1 - 10-05-75R2 Instructions

### Kit No. 800428P consists of:

- 1 - 800428 Bearing Housing
- 1 - 802336 Pulley Bolt Tightening Fixture
- 1 - 838P3 Hardware Kit
- 1 - 10-05-75R2 Instructions

### Kit No. 800429P consists of:

- 1 - 800429 Inner Basket Assembly
- 1 - 802336 Pulley Bolt Tightening Fixture
- 1 - 838P3 Hardware Kit
- 1 - 10-05-75R2 Instructions

**IMPORTANT:** This kit must be installed by a qualified service person.

### Kit No. 802365P consists of:

- 1 - 802365 Inner Basket Assembly
- 1 - 802336 Pulley Bolt Tightening Fixture
- 1 - 838P3 Hardware Kit
- 1 - 10-05-75R2 Instructions

### Kit No. 800749P consists of:

- 3 - 803017 Nut
- 1 - 800749 Trunnion Shaft
- 3 - 800666 Tension Rod Assembly
- 1 - 802336 Pulley Bolt Tightening Fixture
- 1 - 838P3 Hardware Kit
- 1 - 12-03-183R4 Instructions
- 1 - 10-05-75R2 Instructions

### Kit No. 803008P consists of:

- 3 - 803017 Nut
- 1 - 803008 Inner Basket
- 1 - 838P3 Hardware Kit
- 3 - 800666 Tension Rod Assembly
- 1 - 802336 Pulley Bolt Tightening Fixture
- 1 - 12-03-183R4 Instructions
- 1 - 10-05-75R2 Instructions

RSPC®  
P.O. Box 990  
Ripon, WI 54971-0990

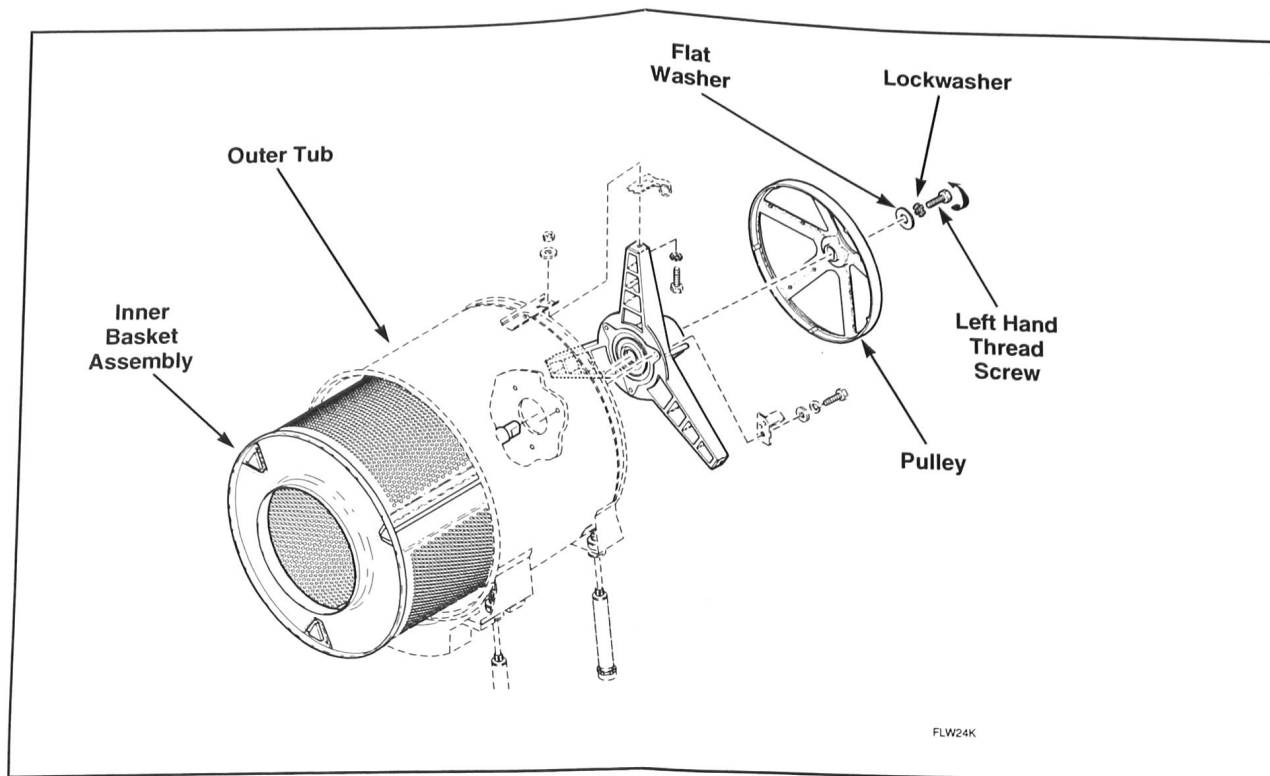

Figure 1

1. Install inner basket assembly by pushing all the way into outer tub.
2. Install pulley, flat washer, lockwasher and left hand thread screw. Refer to *Figure 1*.

**IMPORTANT:** When installing pulley, always use a new cap screw (included in kit) to prevent screw from loosening during operation. Use a thread tap to clean old Loctite out of pulley screw receiving hole before installing new screw. This ensures that inner basket and pulley properly seat.

3. Unscrew left hand thread screw half way.
4. Install pulley bolt tightening fixture between the flat washer and the pulley. Refer to *Figure 2*.
5. Tighten left hand thread screw until washer is against pulley bolt tightening fixture.
6. Loosen screw about one turn to free fixture.
7. Remove pulley bolt tightening fixture.
8. From front of washer, pull inner basket forward as far as possible. Flat washer should be against pulley.
9. Push inner basket back into outer tub as far as possible.
10. Tighten left hand thread screw. Be careful not to push the trunnion shaft forward while tightening the screw.

**NOTE:** Torque new left hand thread screw to 240 minimum to 260 maximum inch pounds (27.5 to 29.7 Nm).

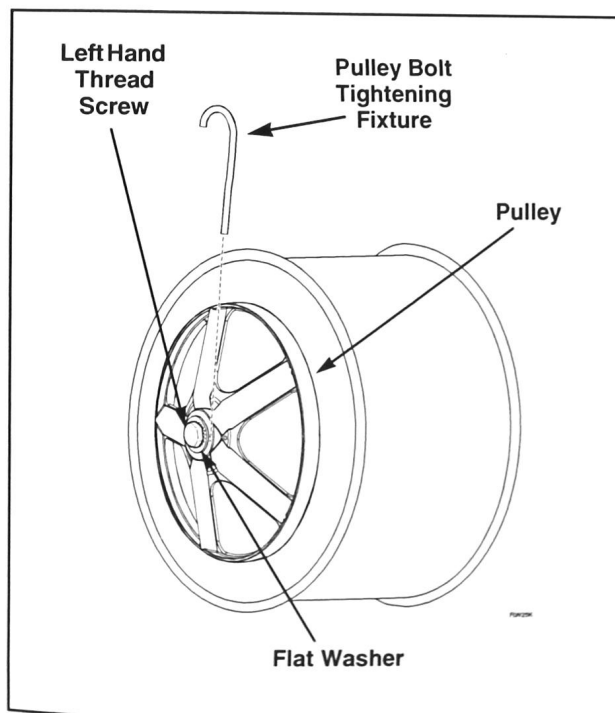

Figure 2