

Important Instructions

Subject Outer and Inner Door Bezel Replacement

Use With Frontload Washers With Larger Door



WARNING

This kit is to be installed in accordance with the manufacturer's instructions and all codes and requirements of the authority having jurisdiction. In Canada, this conversion/installation shall be carried out in accordance with the requirements of the provincial authorities having jurisdiction and in accordance with the requirements of the CAN/CGA-B149.1 and CAN/CGA-B149.2 installation code. Failure to follow instructions could result in serious injury, death or property damage. The qualified agency performing this work assumes all responsibility for this kit installation.

W013R4

To reduce the risk of electric shock, fire, explosion, serious injury or death:

- Disconnect electric power to the washer before servicing.
- Never start the washer with any guards/panels removed.
- Whenever ground wires are removed during servicing, these ground wires must be reconnected to ensure that the washer is properly grounded.

W003

Kit No. 802314P consists of:

- 1 - 802314 Outer Door Bezel
- 1 - 11-07-245R1 Important Instructions

Kit No. 802313*P consists of:

- 1 - 802313* Outer Door Bezel
- 1 - 11-07-245R1 Important Instructions

Kit No. 802616*P consists of:

- 1 - 802616* Outer Door Bezel
- 1 - 11-07-245R1 Important Instructions

Kit No. 802307P consists of:

- 1 - 802307 Inner Door Bezel
- 1 - 11-07-245R1 Important Instructions

Kit No. 802331P consists of:

- 1 - 802331 Inner Door Bezel
- 1 - 11-07-245R1 Important Instructions

Kit No. 802697P consists of:

- 1 - 802697 Outer Door Bezel
- 1 - 11-07-245R1 Important Instructions

Kit No. 804562P consists of:

- 1 - 804562 Inner Door Bezel
- 1 - 11-07-245R1 Important Instructions

* Add Letter To Designate Color. Q – Bisque W – White

IMPORTANT: This kit must be installed by a qualified service person.



Outer Door Bezel

1. Open loading door.
2. Remove 11 T-20 Torx head screws holding outer door bezel to inner door bezel. Refer to *Figure 1*.
3. Pull hinge side of outer bezel away from door and slide forward. Refer to *Figure 1*.

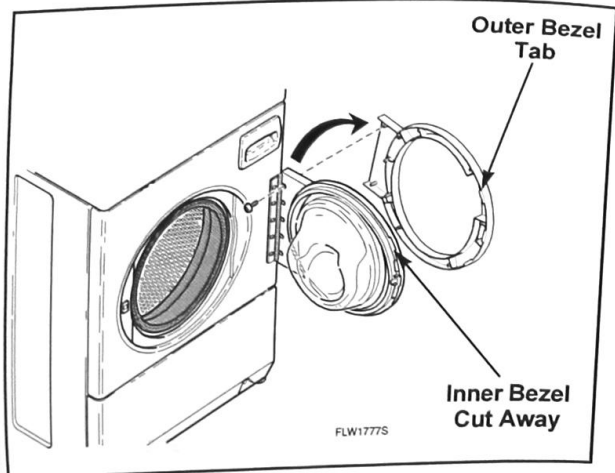

Figure 1

4. Before installing new outer door bezel, check door catch to door lock funnel for proper horizontal alignment. Refer to *Inner Door Bezel* section, step 10, for adjustment.
5. Install new outer door bezel by aligning outer bezel tabs with cut aways on inner bezel and sliding outer bezel into position. Refer to *Figure 1*.

6. Replace 11 screws holding outer door bezel to inner door bezel. Torque screws to approximately 20 inch pounds (2.25 Nm).

IMPORTANT: Do not overtighten screws or bezel holes will strip.

7. Check door catch to door lock funnel for proper vertical alignment. Refer to *Inner Door Bezel* section, step 12, for adjustment.

Inner Door Bezel

1. Remove outer door bezel. Refer to *Outer Door Bezel* section.
2. Remove screws and glass mounting clips holding door glass to inner bezel. Refer to *Figure 2*.
3. Remove door glass.
4. Remove two screws and nuts holding door catch to inner bezel and remove door catch.
5. Remove screws and nuts holding inner bezel to door hinge and remove inner bezel.
6. Attach new inner bezel to door hinge using screws and nuts removed in previous step. Torque nuts to approximately 20 inch pounds (2.25 Nm).
7. Reinstall door catch using screws and nuts. Torque nuts to approximately 30 inch pounds (3.39 Nm).
8. Place glass into inner bezel.

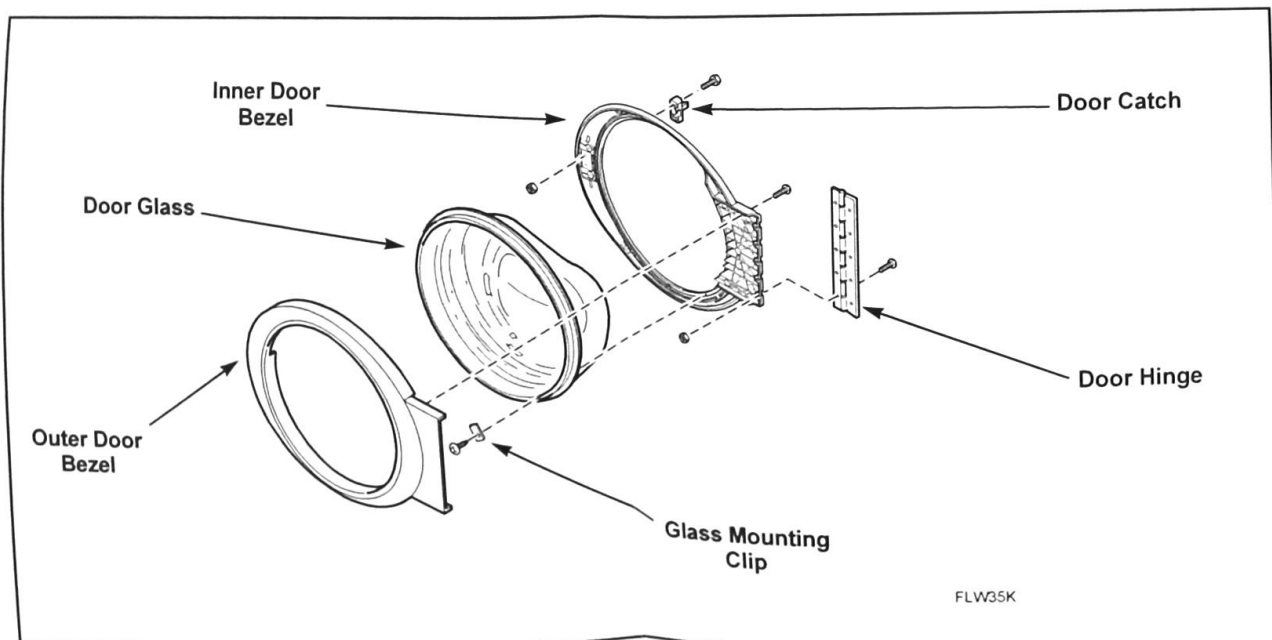

Figure 2

9. Replace screws and glass mounting clips. Torque screws to approximately 20 inch pounds (2.25 Nm).
10. Before replacing outer door bezel, adjust door catch to door lock funnel for horizontal alignment:
 - a. Loosen nuts holding door catch to door.
 - b. Move door catch as far left (when facing machine with door almost closed) as the door lock funnel will allow. Refer to *Figure 3*.

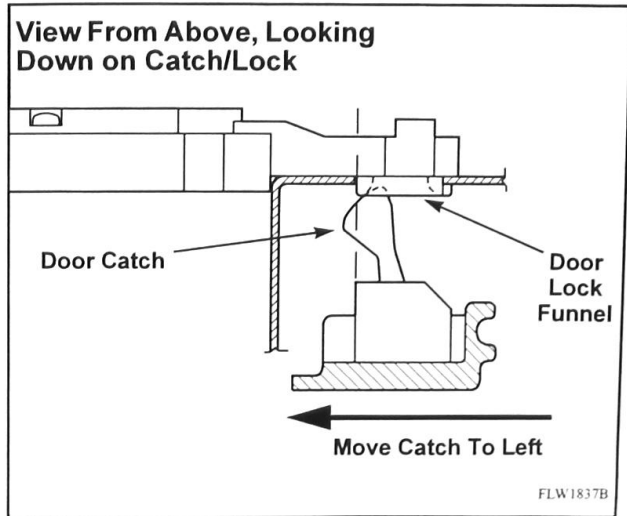

Figure 3

NOTE: Do not move door catch too far or it will not engage the door lock.

- c. Torque nuts to approximately 30 inch pounds (3.39 Nm).
11. Replace outer door bezel. Refer to *Outer Door Bezel* section.
12. Adjust door catch to door lock funnel for vertical alignment:
 - a. Loosen each screw holding door hinge to front panel.
 - b. Swing door open wide to allow weight of door to move door assembly to its lowest point.
 - c. Retighten all screws.

- d. Swing door closed and verify door catch is centered or slightly above center of door lock funnel. Refer to *Figure 4*.

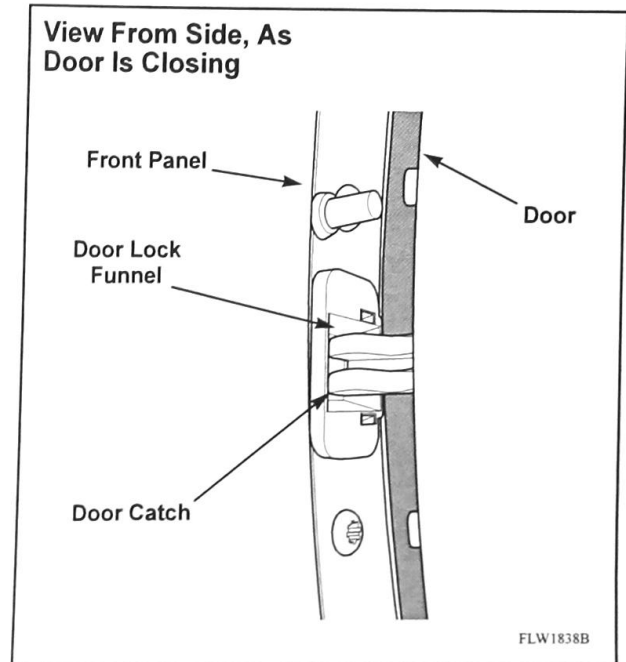

Figure 4

13. Check for proper operation, making sure door locks and unlocks correctly.