

## TE8200 Series Wireless RF433MHz Modulating Room Thermostat

The TE8200 series wireless RF433.92MHz room thermostat proportionally controls Spartan Peripheral Devices ME8200 wireless valve actuator. Mounted on a full range of Spartan Peripheral Device's zone valve bodies (See zone valve body data sheet).

### Specifications

- Communication signal: Wireless RF433.92MHz (USA/Europe Standard) Designed for unlicensed operation under FCC part 15
- Communicating Distance: 90ft (30m) line of sight
- Temperature Measurement Range: 32°F-99°F (0°C-40.5°C)
- Jumper selectable between °C and °F
- Temperature Control Range: 41°F-95°F (5°C-35.0°C) in 1°F (0.5°C) increments
- Supply Voltage: 2 x 1.5V, 3AAA alkaline batteries
- Optional 24Vac, 50/60Hz power
- Sensing Element: NTC thermistor
- Endosure: White ABS
- Approval: Meets CE and ROHS requirements, low voltage class II, 24Vac device as per UL & CSA
- Display LO: When room temperature is below 32°F (0°C)
- Display High: When room temperature is above 99°F (40.5°C)
- Set Point Default: After power is removed the thermostat set point will default to 68°F (20°C) in heating mode and 77°F (25°C) in cooling mode.
- Temperature Display Updates: Every twenty seconds
- Low Battery Indicator: When the power is lower than 2.5V
- Battery Check: At Start Up and every five minutes
- Address Setting: The thermostat has a 9 position dip switch for the possibility of 512 unique address combinations to match the actuator
- Jumper S3: Fahrenheit or Celsius scale selection. Specify °F or °C when ordering for setting by factory
- Freeze Condition Control: When the room temperature is measured at 41°F (5°C) the freeze indicator will display on LCD, the signal will open the valve in the heating mode disregarding the set point.

### TE8200 - Room Thermostat

The TE8200 RFWireless Room Thermostat can transmit up to 90ft (30m) in open space and can be easily controlled and set to the desired temperature via a push buttons.

- The TE8200 is operated by two 1.5AAA batteries or by 24Vac. Easily selectable by internal toggle switch



### TE8250 - Programmable Room Thermostat

The programmable TE8250 RFWireless Room Thermostats on special order only has these additional specifications.

- Real time clock with a day of the week display. Clock accuracy ±2 seconds per day
- Three programs, Monday - Friday, Saturday, Sunday each programme has four events
- 12/24 hour time mode - jumper selectable
- Holiday mode - heating is turned off irrespective of set point (except when in Freeze Condition Control).
- The TE8250 is operated by two 1.5AAA batteries or by 24Vac. Easily selectable by internal toggle switch
- Turns off the display for battery life extension



### Battery Replacement

1. Pull out the battery drawer.
2. Place the new batteries according to the marking on the battery drawer.
3. Dispose the old batteries responsibly.
4. Slide the battery drawer back to its position.
5. Check if the thermostat works properly or not. Press "RST" if necessary.

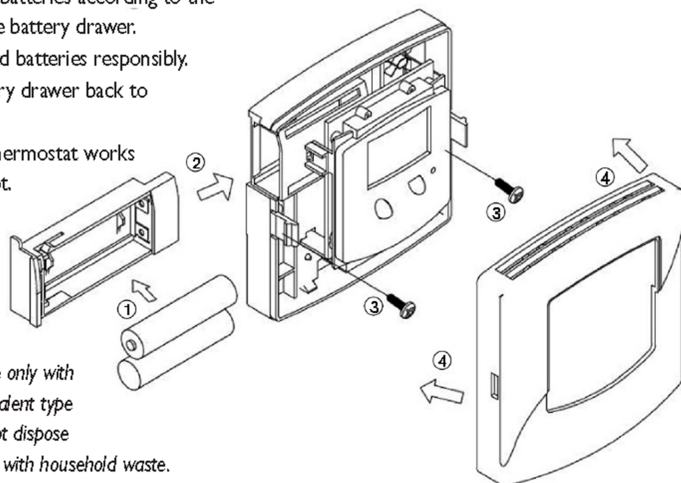

**Caution:** Replace only with the same or equivalent type of batteries. Do not dispose the used batteries with household waste. Refer to your local area for the proper disposal or refer to WEEE Directive.