

AquaSense<sup>®</sup>

TAG \_\_\_\_\_

## ZERK-CP

### E-Z Flush Automatic Retrofit Kit For Closet and Urinal Valves

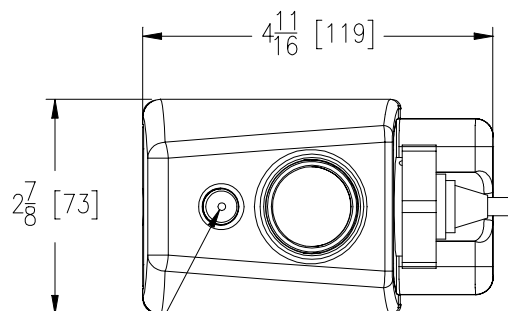
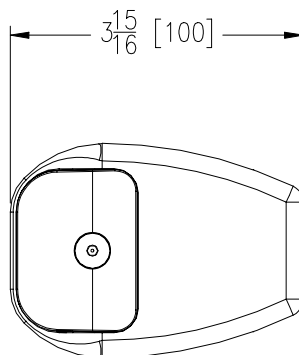

COURTESY FLUSH BUTTON

#### Suffix Options (Check/Specify Appropriate Options)

_____	-LY	Delaney Valve Retro Fit
_____	-HMK	Highmount Adapter
_____	-GM	Sloan/Gem Valve Retro Fit
_____	-MC	Metroflush/Crown Valve Retro Fit
_____	-CB	Cambridge Brass Retro Fit
_____		Other

**ENGINEERING SPECIFICATION:** ZURN ZERK-CP E-Z Flush AquaSense<sup>®</sup> Retrofit Kit- The AquaSense "A" E-Z Flush Unit is designed to provide automatic flushing for urinal and/or water closet flush valves. The unit features an adjustable automatic infrared sensor, user-in-view L.E.D., low battery indicator light, switchable 24 hour auto-flush, 10 degree angled sensor, courtesy flush button, and high impact-resistant chrome plated plastic cover with replaceable tempered glass lens. The unit comes complete with 4 "C" size batteries, wrench for installation, and an allen key for the battery compartment.

This space is for Architectural/engineering Approval

Air Delights, Inc. • COMMERCIAL BRASS OPERATION • 9974 SW ARCTIC DRIVE • BEAVERTON, OR. 97005

Phone: 1-800-440-5556 • Fax: 503-643-8224 • World Wide Web: [www.airdelights.com](http://www.airdelights.com)

In Canada: ZURN INDUSTRIES LIMITED • 3544 Nashua Drive • Mississauga, Ontario L4V1L2 • Phone: 1-800-440-5556 Fax: 503-643-8224

AquaSense<sup>®</sup> is a registered trademark of Zurn Industries, Inc.

Rev. C  
Dwg. No. 63598

Date: 8/22/02  
Product No. ZERK-CP