



© 2008 Lennox Industries Inc.
Dallas, Texas, USA

GAS UNITS KITS AND ACCESSORIES

506155-01
08/2008

TP Technical
Publications
Litho U.S.A.

REPLACEMENT COMBUSTION AIR INDUCER

INSTALLATION INSTRUCTIONS FOR REPLACEMENT COMBUSTION AIR INDUCER KITS (24W95 & 43W85) FOR USE ON G40, G50 & G60 FURNACES

Shipping & Packing List

Package 1 of 1 contains the following:

- 1 - Combustion air inducer (CAI) assembly
- 2 - Replacement gaskets
- 4 - #8-18-1/2" screws
- 1 - 7" length of tubing (used in single-stage applications, -14 and earlier)
- 1 - 9" length of tubing (used in two-stage applications, -8 and earlier)

Application

These combustion air inducer replacement kits are applied as necessary to furnaces as listed in table 1.

TABLE 1

Model Numbers	Kit Catalog Number
G40UH, G40DF, G50UH & G50DF	24W95
G60UH(V) G60DF(V)	43W85

G40DF, G40UH, G50DF and G50UH Units with Dash Numbers of 14 or Earlier or G60DF(V) and G60UH(V) Units with Dash Numbers of 8 or Earlier -- Existing pressure switch may not be compatible with replacement combustion air inducer. Check pressure switch part number against required part number listed in table 2 and replace if necessary.

Installation

! WARNING

Disconnect power before servicing unit.

Shut off main gas supplies to appliance until installation is complete.

! IMPORTANT

Improper installation, adjustment, alteration, service or maintenance can cause property damage, personal injury or loss of life. Installation and service must be performed by a qualified installer, service agency or the gas supplier.

! CAUTION

As with any mechanical equipment, personal injury can result from contact with sharp sheet metal edges. Be careful when you handle this equipment.

- 1 - Turn off the electrical power and gas supply to the furnace.
- 2 - Disconnect the vent connector or vent pipe from the flue transition.
- 3 - Remove the upper access panel and cabinet top cap.
- 4 - Disconnect the wires from the existing combustion air inducer motor. These wires supply electrical power to the inducer assembly. See figure 2 for single-stage units and figure 3 for two-stage units.
- 5 - Disconnect the flexible pressure switch hose from the pressure tap or barbed fitting on the inducer housing. See figure 2 or figure 3. Replace the pressure switch hose with the provided 7" hose on G40DF, G40UH, G50DF and G50UH units with dash numbers of 14 and earlier. Replace the pressure switch hose with the provided 9" hose on G60DF(V) and G60UH(V) units with dash numbers of 8 and earlier.

TABLE 2

Model Numbers	0 - 7,500 feet			7,501 - 10,000 feet		
	Pressure Switch Catalog Number	Pressure Switch Part Number	Setpoint (inches w.c.)	Pressure Switch Catalog Number	Pressure Switch Part Number	Setpoint (inches w.c.)
G40UH, G50UH	24W97	101231-01	0.40	56L32	56L3201	0.36
G40DF, G50DF	24W98	101231-02	0.31	24W98	101231-02	0.31
G60UHV	18M61	18M6101	0.20/0.40	18M64	18M6401	0.20/0.35
G60DF(V)	18M64	18M6401	0.20/0.35	44W31	102052-01	0.20/0.30

NOTE - Pressure switch is factory-set. No adjustment is necessary.



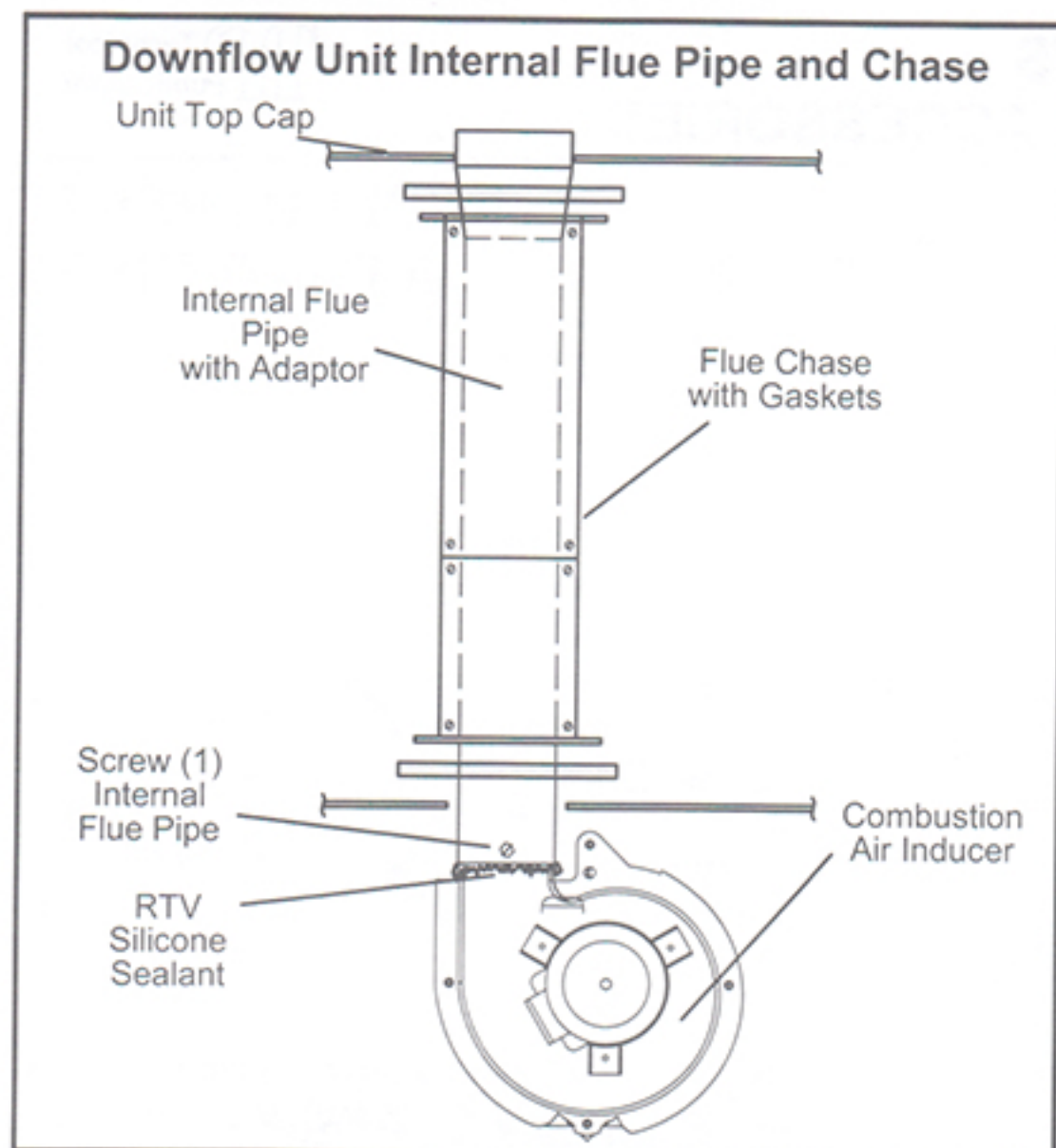

FIGURE 1

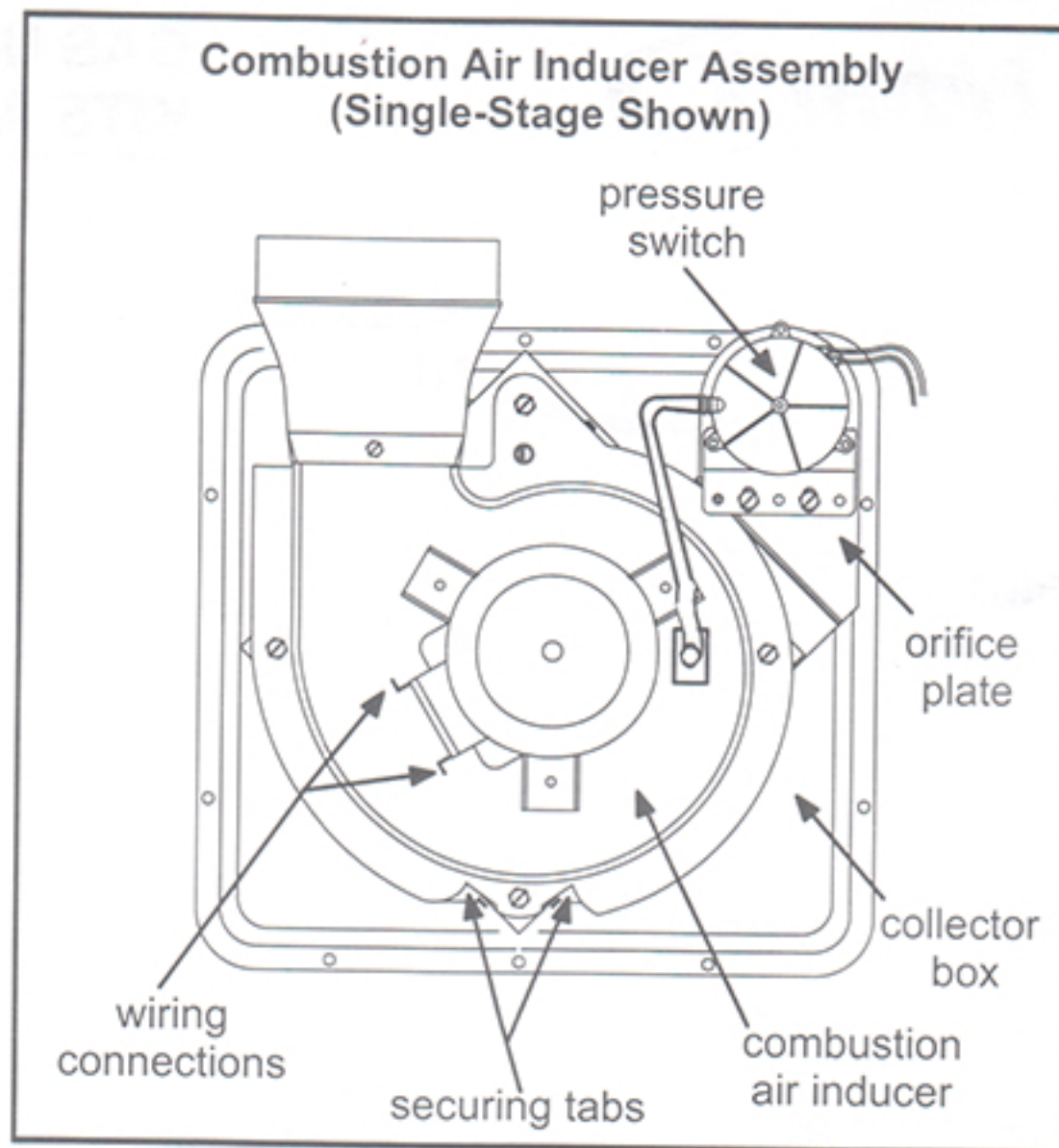

FIGURE 2

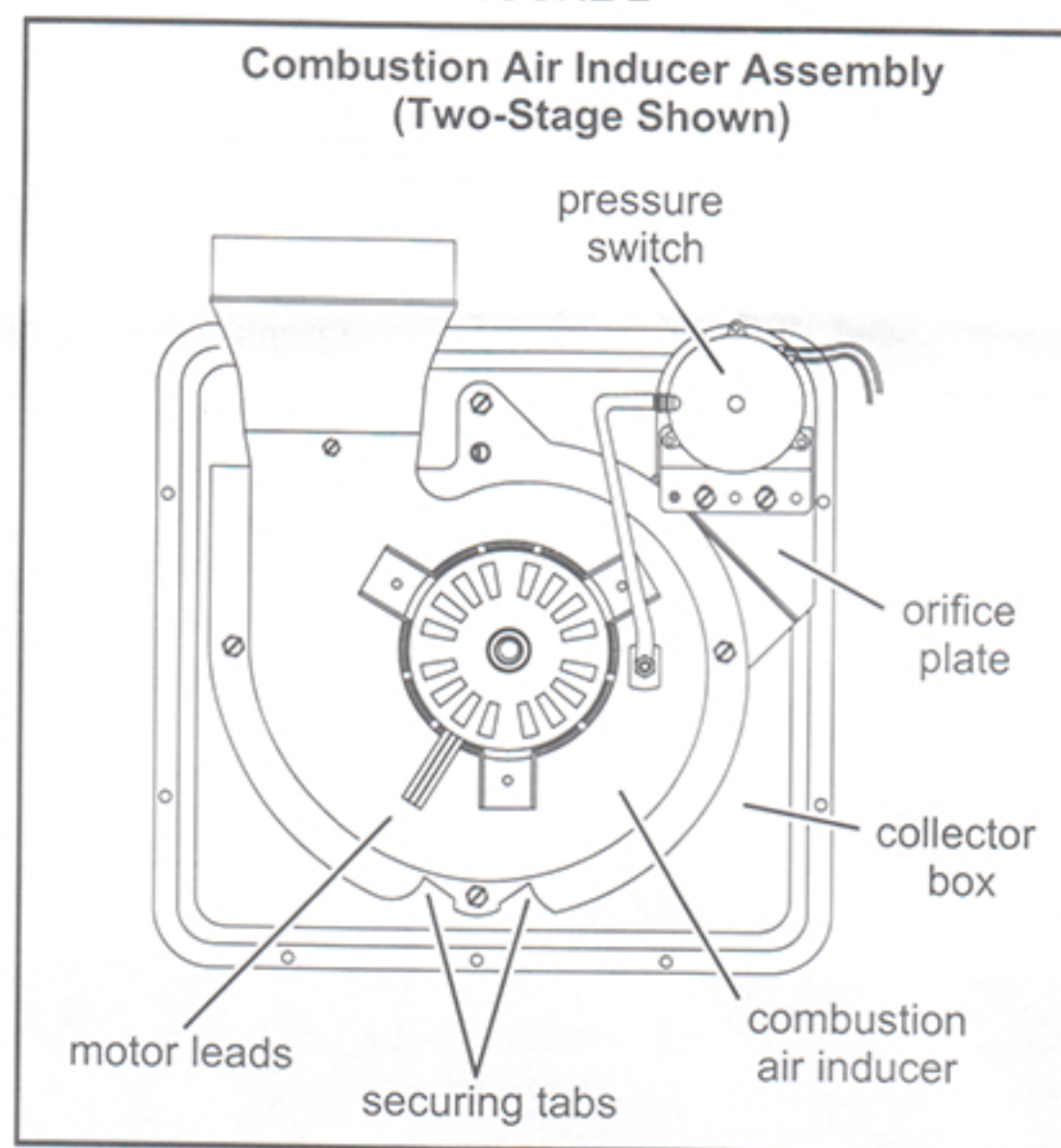

FIGURE 3

- 6 - Remove the two screws which secure the pressure switch assembly to the orifice plate. Remove the pressure switch assembly and swing it clear of the inducer area. Allow the switch assembly to be supported by its wires. See figure 2 or figure 3.
- 7 - **Downflow Units Only** -- Remove the screw that secures the internal flue pipe to the combustion air inducer. See figure 1.
- 8 - Remove the four screws that secure the combustion air inducer assembly to the flue collector box. Remove the inducer assembly from the furnace. See figure 4 for single-stage units and figure 5 for two-stage units.
- 9 - **Upflow/Horizontal Units Only** -- Remove the flue transition from the existing inducer assembly and install it on the replacement inducer assembly.
- 10 - Bend the three tabs on the combustion air inducer orifice plate backward. These tabs secure the orifice plate to the inducer housing. See figure 2 or figure 3. Discard the old gasket.
- 11 - Extend the alignment tab on the orifice plate through the replacement gasket and inducer housing. See figure 4 or figure 5.
- 12 - Bend the three orifice plate tabs over to secure the plate and gasket to the inducer housing.
- 13 - Insert the second replacement gasket between the flue collector box and the orifice plate.
- 14 - Use the four provided screws to secure the replacement inducer assembly to the flue collector box.
- 15 - Reinstall the pressure switch on the orifice plate.

- 16 - Reconnect the hose to the pressure tap or barbed fitting on the inducer housing. Make sure that each end of the hose is securely attached. Use replacement hose if existing hose is not long enough.
- 17 - Reconnect the wires to the combustion air inducer motor.
- 18 - Reinstall the cabinet top cap and upper access panel.
- 19 - **Downflow Units Only** -- Scrape away existing Silicone sealant from the internal flue pipe. Apply RTV/high temperature silicone sealant between the internal flue pipe and the combustion air inducer. See figure 1.

20 - **Upflow/Horizontal Units Only** -- Reconnect the vent connector or vent pipe to the flue transition.
Downflow Units Only -- Secure the internal flue pipe to the combustion air inducer using the existing screw. See figure 1.

21 - Restore the electrical power and gas supply to the furnace. Initiate a call for heat and check that the furnace is operating properly.

22 - See the unit installation instructions for the start-up procedure.

23 - **Manifold pressures for single-stage units:** 3.5" w.c. for natural gas units and 10.0" w.c. for units fueled by LP/propane gas.

Manifold pressures for two-stage units: 1.7" w.c. (low) and 3.5" w.c. (high) for natural gas units and 4.9" w.c. (low) and 10.0" w.c. (high) for units fueled by LP/propane gas.

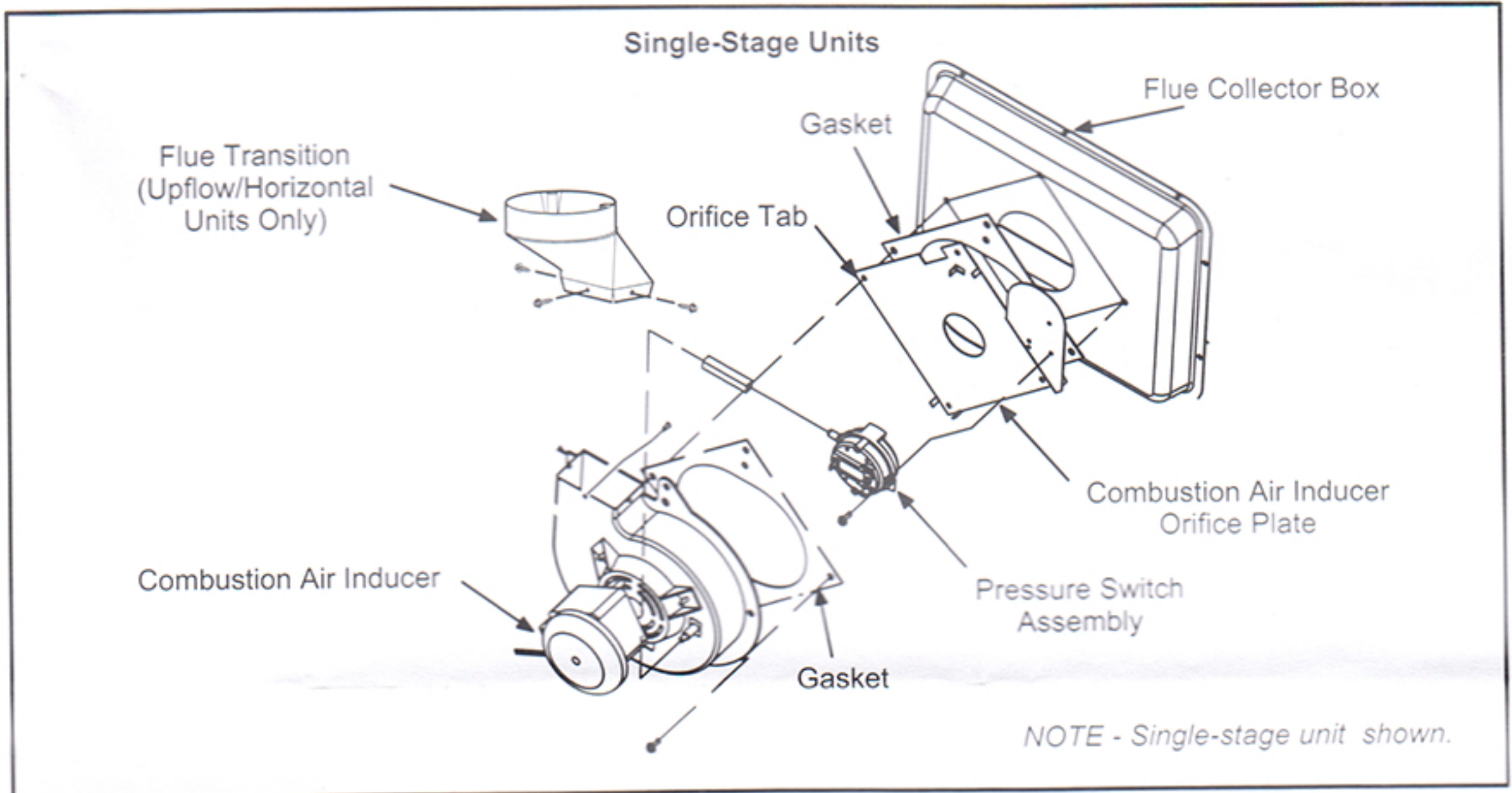

FIGURE 4

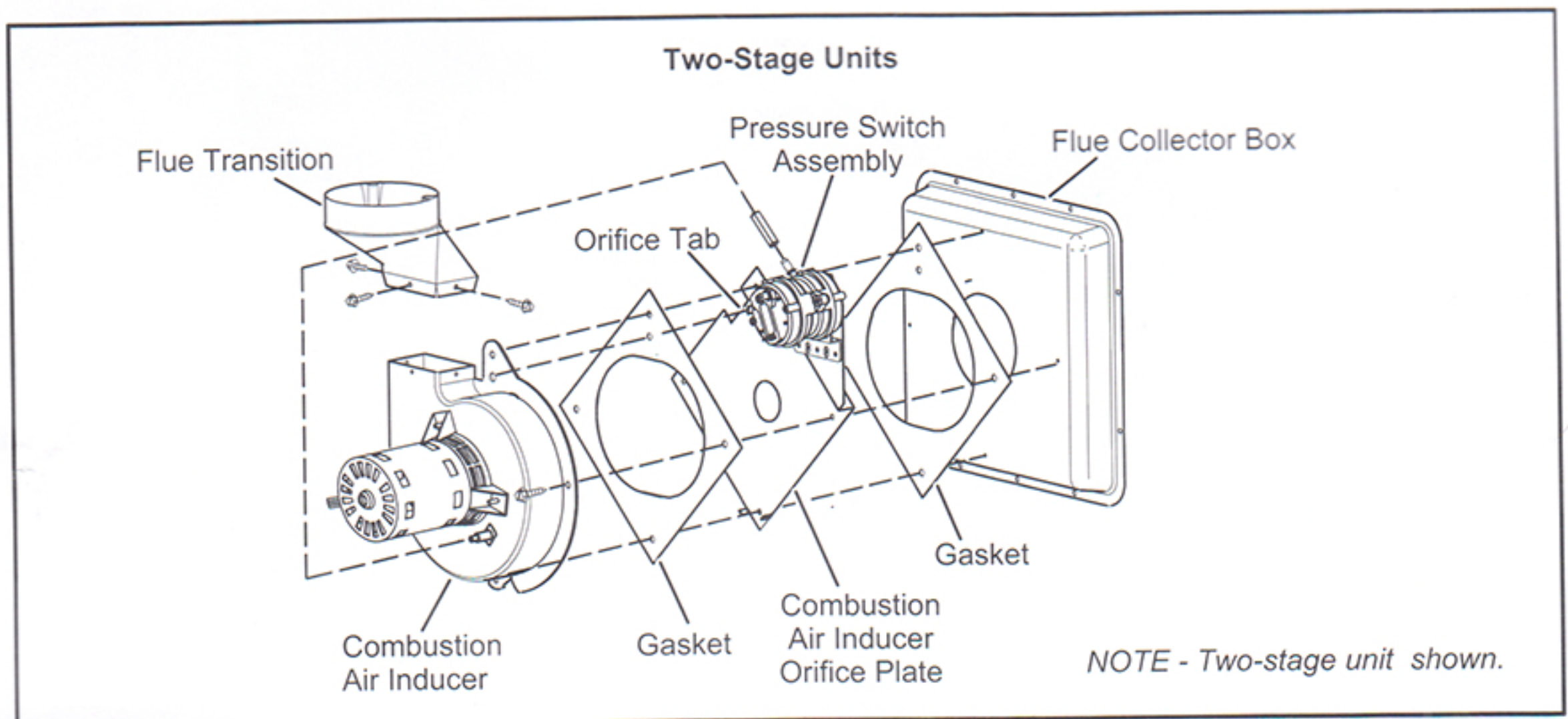

FIGURE 5