



Spartan Chemical Company, Inc.

1110 Spartan Drive, Maumee, OH 43537

1-800-537-8990

Spartan®

www.spartanchemical.com

TO FILL DISPENSER

1. OPEN CASE



YOU MUST INSERT
THE REMOVABLE KEY
UNLESS YOU HAVE
INSTALLED THE
PERMANENT KEY.

2.

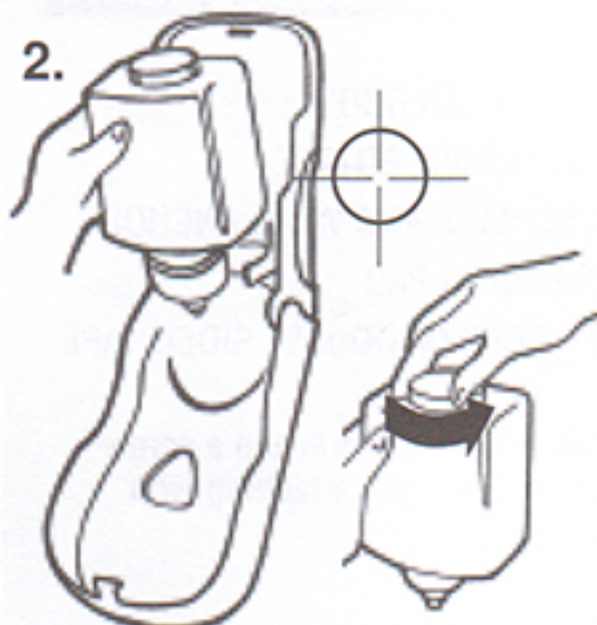

REMOVE
CONTAINER

UNSCREW CAP

3. RINSE OUT BOTTLE AND PUMP MECHANISM THOROUGHLY WITH WARM WATER TO REMOVE RESIDUE AND CONTAMINANTS.

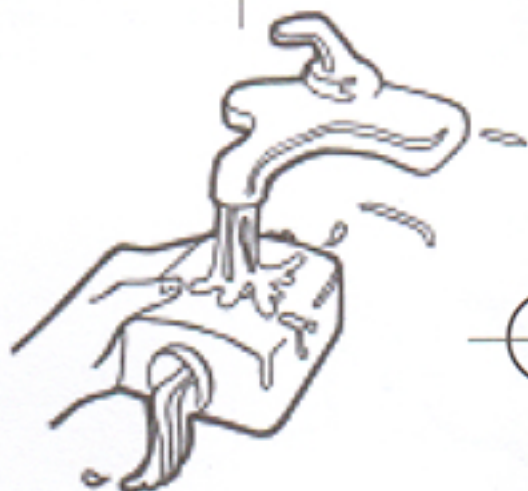

NOTE: If a filled dispenser will not be used for two weeks or longer (ie. theme park, winter shutdown, summer school break, etc.) remove Lite 'n Foamy® soap from the dispenser reservoir, rinse out and reinstall.

4. FILL WITH LITE 'n FOAMY® PRODUCT.



5. REPLACE CAP AND SNAP CONTAINER INTO THE CASE.

CLOSE THE CASE.

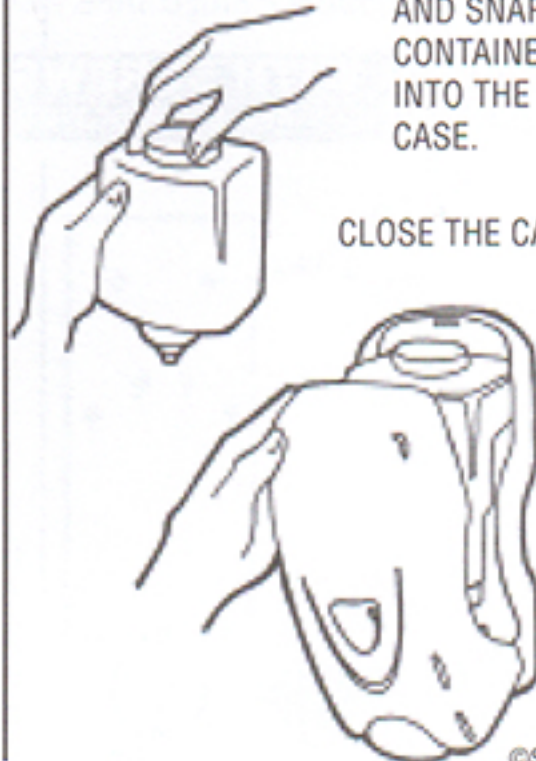

LITE'n FOAMY® DISPENSER INSTALLATION

PACKAGE INCLUDES

DISPENSER BODY
REFILLABLE BOTTLE
4 SCREWS AND WALL ANCHORS
CLEANING PAD
2 PIECES OF DOUBLE SIDED TAPE

You will need a drill and a screw driver if you are attaching with screws.

CAUTION:

It is the responsibility of the installer to completely read and understand all instructions and caution statements before proceeding with installation. Following these instructions will ensure proper function and safety.

BEFORE INSTALLING DECIDE IF THE UNIT WILL BE UNIVERSALLY ACCESSIBLE or YOU WILL USE A KEY TO OPEN IT.

KEYS



REMOVABLE KEY



PERMANENT KEY

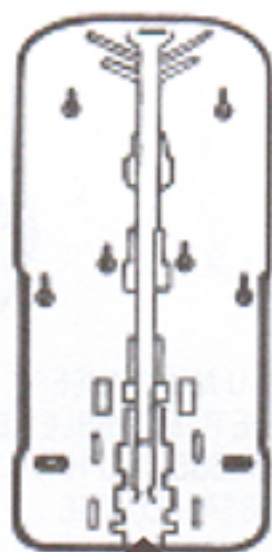

INSERT
KEY

MOUNTING TO WALL WITH TAPE

For glaze tile, painted metal or unpainted metal walls

1.



CLEAN THE SURFACE FIRST WHEN MOUNTING WITH DOUBLE SIDED TAPE.

2.

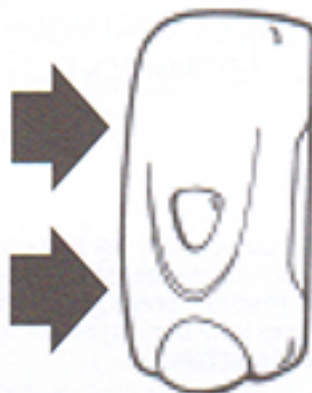

WAIT 24
HOURS
BEFORE
FILLING

PEEL OFF BACKING
PRESS UNIT FIRMLY TO WALL

MOUNTING WITH SCREWS

For porous surfaces like brick or wood.

1.



USE TEMPLATE ON
THE BACK OF THIS
SHEET TO MARK AND
DRILL 5mm DRILL
PILOT HOLES.

2.

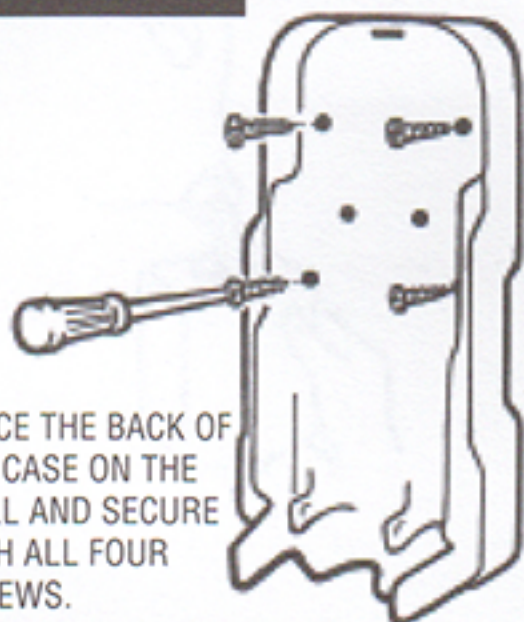

PLACE THE BACK OF
THE CASE ON THE
WALL AND SECURE
WITH ALL FOUR
SCREWS.