

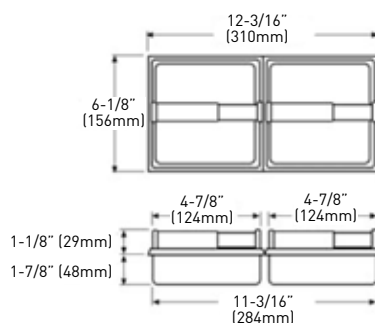

TWIN RECESSED PAPER HOLDER

- RECESSED CONTAINER HOUSING WITH COUNTERSUNK MOUNTING HOLES
- INCLUDES #8 x 1-1/4" (32mm) MOUNTING SCREWS FOR SCREW-IN APPLICATION
- WALL OPENING: 11-3/16 (284mm) x 5-1/8 (130mm)
- POSTS SECURELY RIVETED TO HOUSING
- ROLLER
- CONSTRUCTION: WHITE PLASTIC WITH SPRING TENSION



PKG	C26 POLISHED CHROME	CASE PACK
C	01-TW101S	10

C = CONTRACTOR PACK



RECESSED EXTRA ROLL PAPER HOLDER

- RECESSED CONTAINER HOUSING WITH COUNTERSUNK MOUNTING HOLES
- INCLUDES #8 x 1-1/4" (32mm) MOUNTING SCREWS FOR SCREW-IN APPLICATION
- WALL OPENING: 5-5/16 (135mm) x 5-5/16 (135mm)
- POSTS SECURELY RIVETED TO HOUSING
- RECESSED CONTAINER
- CONSTRUCTION: GALVANIZED SHEET METAL
- ROLLER
- CONSTRUCTION: WHITE PLASTIC WITH SPRING TENSION

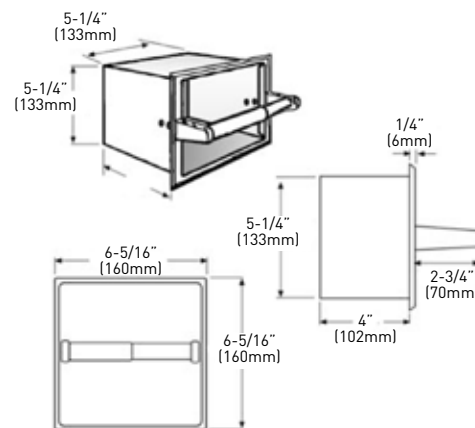

PKG	C26 POLISHED CHROME	CASE PACK
C	01-1070	10

C = CONTRACTOR PACK



RECESSED SOAP HOLDER

- RECESSED CONTAINER HOUSING WITH COUNTERSUNK MOUNTING HOLES
- INCLUDES #10 x 2" (51mm) MOUNTING SCREWS FOR SCREW-IN APPLICATION
- WALL OPENING: 5-1/8" (130mm) x 5-1/8" (130mm)
- NON-REMOVABLE SOAP DISH

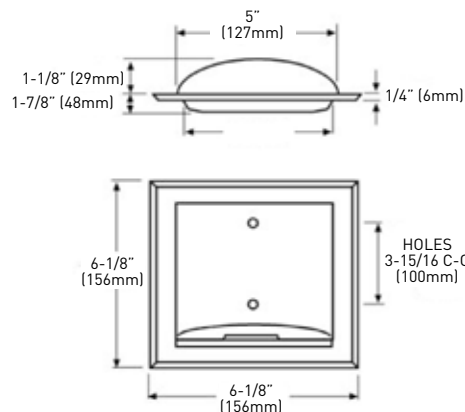

PKG	C26 POLISHED CHROME	CASE PACK
C	01-1861C	50
C	01-1861S	50

C = CONTRACTOR PACK