

## TrueEASE™ Humidification System

### PROFESSIONAL INSTALLATION GUIDE

#### INCLUDED IN THIS HUMIDIFIER BOX

GETTING  
STARTED

MOUNTING

PLUMBING

WIRING

OPERATION  
AND SERVICE

APPENDICES

A



B

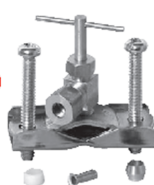

C



D



E



F



G



#### Tools needed to install humidifier

- Wire cutter/stripper
- Tin snips or sheet metal cutter
- #8 hex nut driver
- Standard screwdriver
- 18-gauge wire (up to 5 conductor)

#### Other Requirements

- If floor drain is not available, refer to Appendix C for additional plumbing parts consideration.
- If installed in or above a finished space, Honeywell recommends installing a drip pan with water sensor shut-off.

- A Humidifier Bypass
  - B Saddle valve
  - C Water supply line
  - D Drain hose (10 feet)
  - E Owner's manual
  - F Mounting template
  - G Low-Voltage SPST Manual Humidistat
- Hardware (not pictured)  
Additional accessories included in select models

#### Cross Reference Table

Humidifier	Honeywell®	Aprilaire®	GeneralAire®
HE100 and HE150	HE225	500	570
HE200 and HE250	HE265	600	900
HE300	HE365	700	1000



33-00067EF-01



# Humidifier

## GETTING STARTED

Safety Definitions and Precautions .....	2
What to Expect From Your Humidifier .....	3
Important Installation Requirements .....	4

## MOUNTING

Choosing a Mounting Method .....	5
<b>STEP ONE:</b> Select the Mounting Location. ....	6
<b>STEP TWO:</b> Install Mounting Template to the Duct .....	6
Bypass Model Installation .....	7
<b>STEP THREE:</b> Configure Humidifier Bypass .....	7
<b>STEP FOUR:</b> Installation .....	8
<b>STEP FIVE:</b> Bypass Duct Installation .....	9

## PLUMBING

Water Supply and Drain Connections .....	10
<b>STEP ONE:</b> Connect the Water Supply .....	10
<b>STEP TWO:</b> Tap into a Water Line .....	10
<b>STEP THREE:</b> Connect to the Water Drain ....	11

## WIRING

Before Wiring Humidifier .....	12
<b>STEP ONE:</b> Remove the Humidifier Cover ....	12
<b>STEP TWO:</b> Install the Transformer (Bypass Models Only) .....	12
<b>STEP THREE:</b> Wiring Humidifier .....	12
Installing the Humidistat .....	13
Duct Installation (H8908) .....	13-14
Remote Installation (H8908) .....	14
Humidistat Wiring .....	15-17
Humidistat Checkout .....	18
Humidistat Operation .....	18

## OPERATION AND SERVICE

Startup and Checkout .....	19
Routine Maintenance .....	20
Troubleshooting .....	21

## APPENDICES

A: Specifications .....	22
B: Advanced Draining .....	23
C: Parts List .....	24-25



**NEED HELP?** For assistance with this product please visit <http://yourhome.honeywell.com> or call Honeywell Customer Care toll-free at 1-800-468-1502.



## Read and save these instructions.

© U.S. Registered Trademark. Patents pending. Copyright © 2014 Honeywell International Inc. All rights reserved.

# Safety Definitions and Precautions



## Safety Definitions

These safety terms identify information you must read prior to installing or operating the humidifier.

-  **CAUTION:** Indicates a hazardous situation which, if not avoided, could cause bodily injury or property damage.
-  **WARNING:** Indicates a hazardous situation which, if not avoided, could result in death or serious injury.

## Safety Precautions

Make sure you read and understand the following safety hazards before installing, using, or working with the humidifier:

-  **CAUTION:** Voltage Hazard.  
Can cause electrical shock or equipment damage.  
Disconnect HVAC equipment and any electrical outlet being used for the humidifier installation.
-  **WARNING:** Electrocution and Water Hazard.  
Can cause death, blindness, and water damage to the home and HVAC Equipment.
-  **CAUTION:** Condensation, Fire, and Freezing Water Hazard.  
Can cause failure of fan or limit control or result in water damage to home.

.....

# What to Expect From Your Humidifier

The installer should review these points with the homeowner and answer any questions they have before leaving the job site.

- **Achieving Humidity Setpoint.** It may take up to a week of continuous operation to achieve the humidity setpoint, especially if the home is dry when the humidifier is installed. This also depends on such factors as weather, size of home, furnishings in the home, and insulation.
- **Ideal Humidity.** Home building industry experts cite 35% relative humidity as ideal for comfort and safeguarding the home during the typical dry season. Homeowners can adjust to their own comfort or until there is condensation on the windows. Lower the setpoint if condensation appears.
- **Unit Not Humidifying.** If the humidifier is not running but the humidity is below the setpoint, the humidity control may have a frost protection setting to prevent window condensation from appearing.
- **Home Ventilation.** Excessive ventilation sends moist air outside and replaces it with dry air. This can make it hard to maintain the humidity setpoint. If installing a ventilator, use a solution that retains moisture. An Energy Recovery Ventilator (ERV) is recommended.
- **Cleaning Requirements.** At least once per year it is recommended to change the humidifier pad and clean the water trays of the humidifier. See Operation and Service section for details.
- **Energy Consumption.** It is important to explain that with any humidification solution there is a cost associated with converting water to humidity. The humidifier utilizes the air heat and air flow in your ducting to make this conversion, which has gas and/or electric costs that depend on your HVAC system type and setup.

# Important Installation Requirements

Failure to comply with these requirements will result in voided warranty, improper installation, and service callbacks.

## Personal Safety

- Wear safety glasses while installing the humidifier.
- Do not cut into any air conditioning or electrical line.
- Follow professional safety standards and all local regulations for plumbing, electrical, and mechanical considerations.

## Mounting Location

- Mount the humidifier in a level position to avoid water damage and ensure maximum output.
- Location must have access to a water line, drain, and power.
- Do not install the humidifier where the ambient temperature is lower than 34°F (1.1°C) or higher than 90°F (40°C).
- Mounting area must be strong enough to support humidifier weight (up to 16 lbs [Fan] or 10 lbs [Bypass]).
- Do not mount directly to ductboard.
- If used near a pool or spa, make sure the humidifier can not fall into the water or be splashed.
- Ensure that the top and bottom covers of the humidifier can be removed and that the pad is accessible from the chosen location.

## Water Supply and Drainage

- Consult local plumbing codes for drain size, material, and maximum temperature allowed.

## If Replacing an Old Bypass Humidifier

The humidifier is not identical in size and shape to other Honeywell bypass humidifiers. Before performing a retrofit installation, you might need to:

- Dry-fit the humidifier to the existing ducting, plumbing, and wiring before fastening it to the duct to ensure that the existing connections will reach the humidifier.
- If the duct opening of the old humidifier is not the right size for the humidifier, choose a new location or cover the old opening with a piece of sheet metal and cut a new opening specifically for the humidifier using the template provided.

**Cross Reference Table**

Humidifier	Honeywell®	Aprilaire®	GeneralAire®
HE100 and HE150	HE225	500	570
HE200 and HE250	HE265	600	900
HE300	HE365	700	1000

## Choosing a Mounting Method

### **Bypass:**

Bypass humidifiers use the pressure difference between the supply and return to move duct air through the humidifier. Access to both the supply and return are required. The bypass humidifier can be positioned on either the supply or return duct.

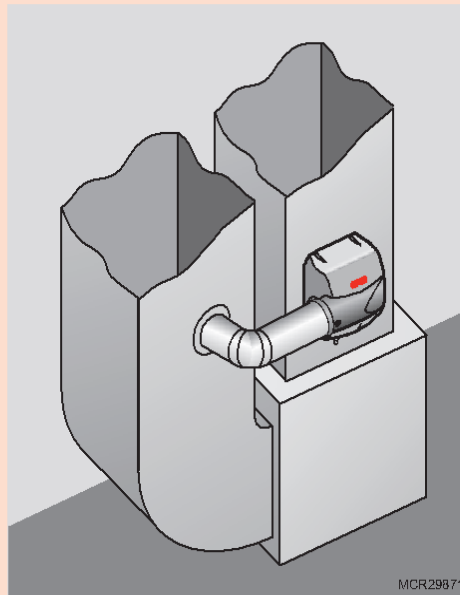

### Before beginning Mounting:

- ☐ I have confirmed local codes for proper plumbing practices.
- ☐ I have chosen an installation location that meets the requirements on page 4.

## STEP ONE: Select the Mounting Location

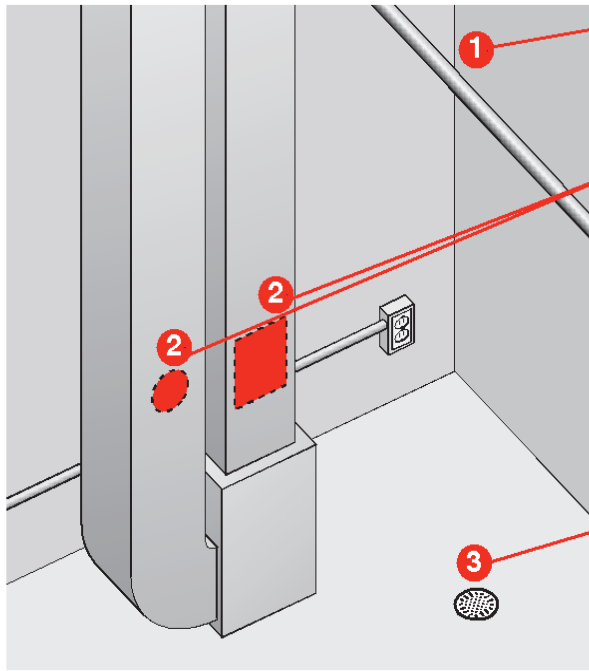

MCR29877

Choose a location that has access to a water supply pipe. Cold or hot water can be used.

Select a vertical or horizontal surface on the HVAC duct work, with adequate space clearances, where the humidifier can be mounted.

Ensure the location is near a drain. Consult local plumbing codes for proper drainage. If no main floor drain is available, see "Appendix C: Advanced Draining."

## STEP TWO: Install Mounting Template to the Duct

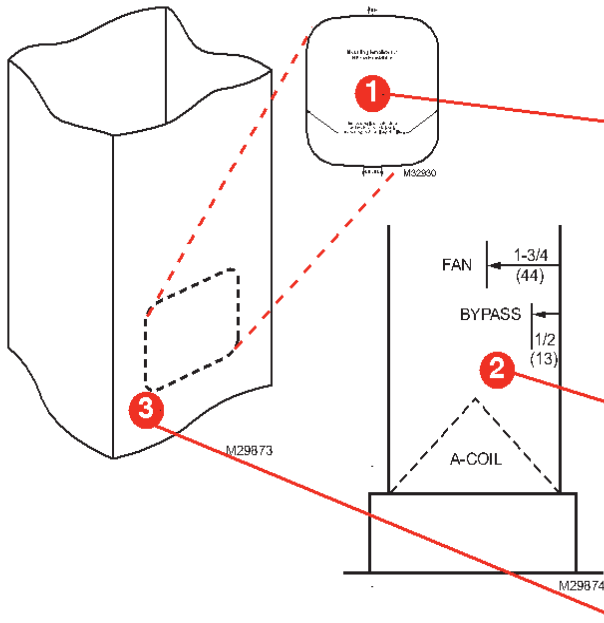

Position the template on the duct.

- Make sure the template is level and in the desired position on the duct. Peel adhesive backing and press template firmly into place in desired mounting location.

Ensure proper clearances from the air-conditioning coil inside the duct.

NOTE: Bypass models extend into the duct 1/2 inch. Ensure clearance inside the duct.

- For best performance, maintain at least 24 inches downstream of open air space inside the duct.

Cut the sheet metal, following the template outline.



# Bypass Model Installation

## STEP THREE: Configure Humidifier Bypass

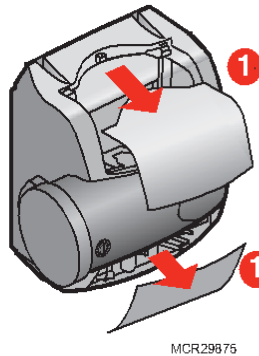

Configure the humidifier bypass outlet to the side that best fits the application.

If the bypass needs to be on the other side, remove the top and bottom covers.

MOUNTING

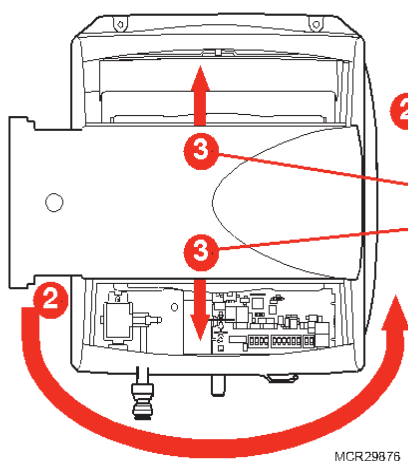

Unplug the damper wire and plug in on the other side (HE150/HE250 only).

Pull the bypass clamps apart from center to remove the bypass; snap it back into place with the outlet on the desired side.

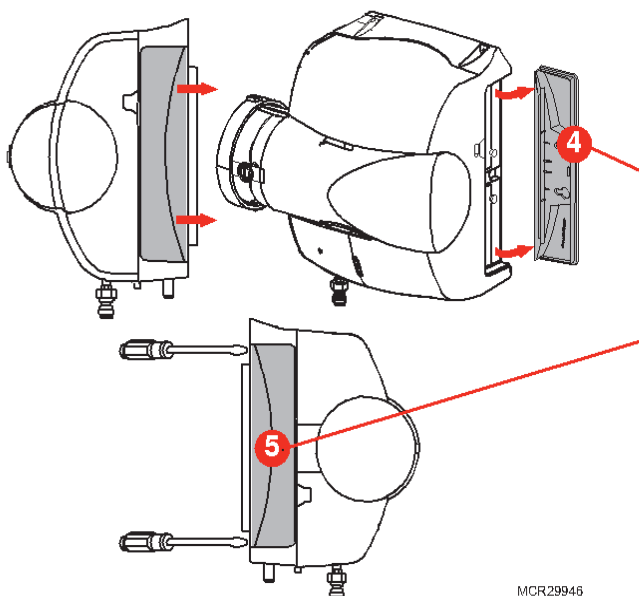

Ensure that the pad is accessible. The handle of the pad holder and side panel of the humidifier can be switched so the pad holder can be removed (opposite side of the bypass duct opening).

To remove the handle for the pad holder, slide it toward the back of the humidifier, then pull it away from the humidifier.

To remove the opposite side panel, place a screwdriver into the two slots on the back of the humidifier, and pop the panel off.

Snap the pad holder handle and side panel back into place in the desired configuration.

# Bypass Model Installation

## STEP FOUR: Mounting

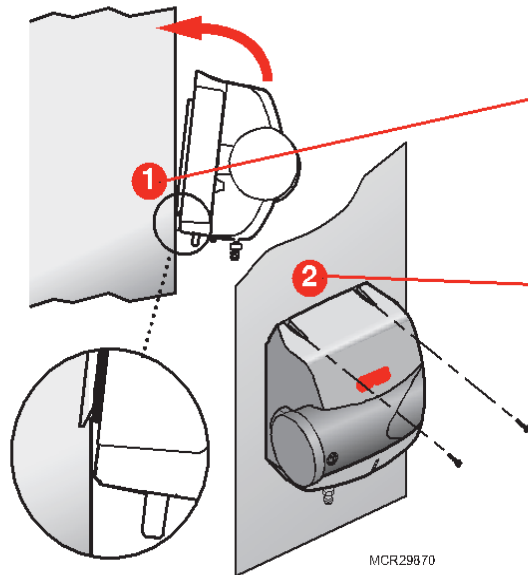

Secure the support hooks on Bypass models to the bottom lip of the hole.

Push the top of the humidifier back against the duct.

Verify the humidifier is level and fasten the humidifier to the duct using two self-drilling sheet metal screws provided.

# Bypass Model Installation

## STEP FIVE: Bypass Duct Installation

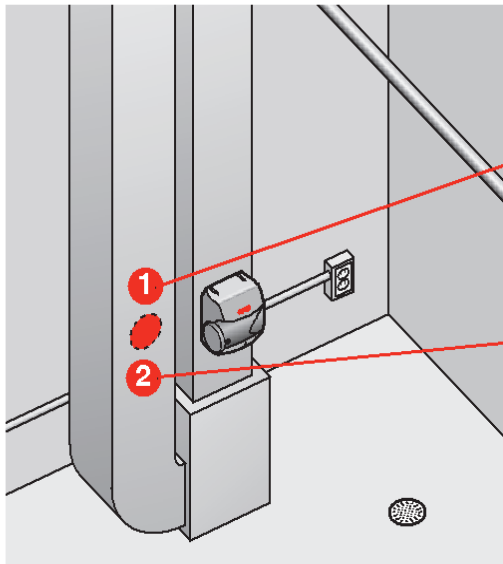

On the duct opposite the humidifier Bypass install, cut a 6-in. diameter duct hole.

- If the humidifier is on the supply duct, the 6-in. diameter hole should be on the return.
- If the humidifier is on the return duct, the 6-in. diameter hole should be on the supply.

Secure a 6-in. round duct starter collar into the 6-in. duct hole.

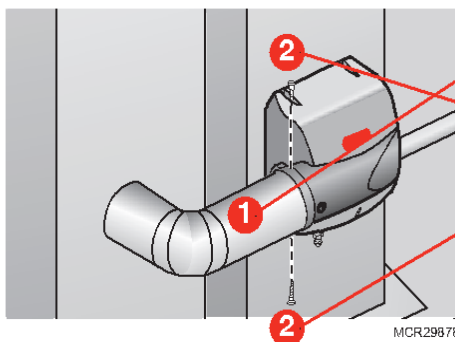

Use rigid or aluminized flexible 6-in. duct to connect the starter collar to the humidifier bypass port.

Secure the duct to the humidifier port with self-drilling sheet metal screws using the pre-drilled holes on the bypass port. For added seal, wrap sheet metal tape around the duct to port connection point.

Before proceeding to the next step:

☐ I secured the humidifier to the duct as instructed.

# Water Supply and Drain Connections

## STEP ONE: Connect the Water Supply

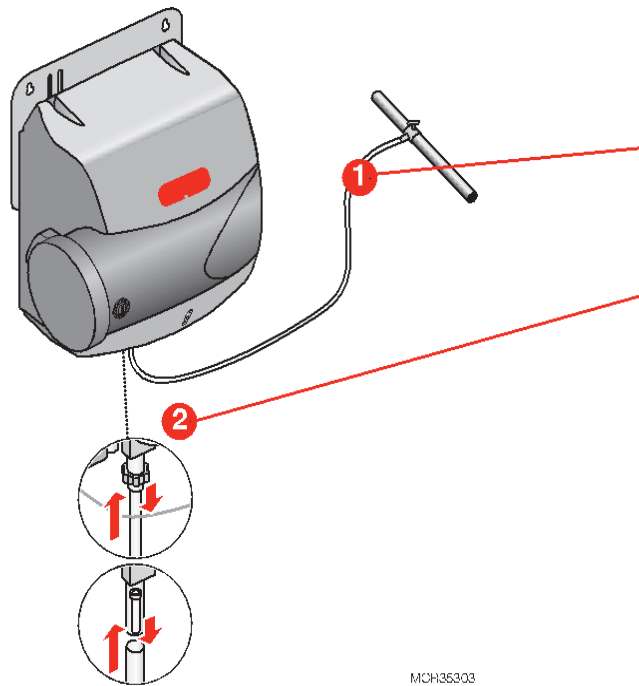

Use hot or cold water.

Cut the water line so it reaches from the humidifier to the main water supply tap.

Insert the water line into the gray quick connect fitting. Insert it fully, and apply modest pull pressure to ensure a tight fit.

Note: The quick connect fitting can be removed if you prefer to use a standard 1/4-in. brass compression nut plumbing connection. Do not remove the conical screen if you select this option.

PLUMBING

## STEP TWO: Tap into a Water Line

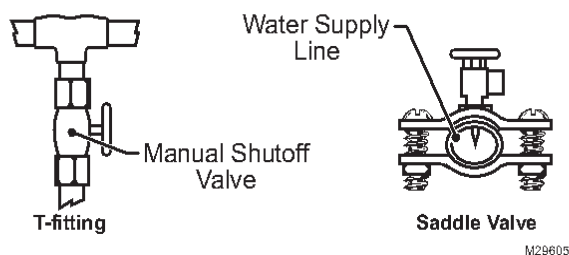

- Consult local codes for proper plumbing.
- Use the saddle valve provided or a T-fitting and manual shutoff valve to tap into the water line.
- Refer to the literature included with the valve you chose and the local plumbing codes. Use proper technique for the valve.
- Connect the other end of the humidifier water line to the water valve.

### STEP THREE: Connect to the Water Drain

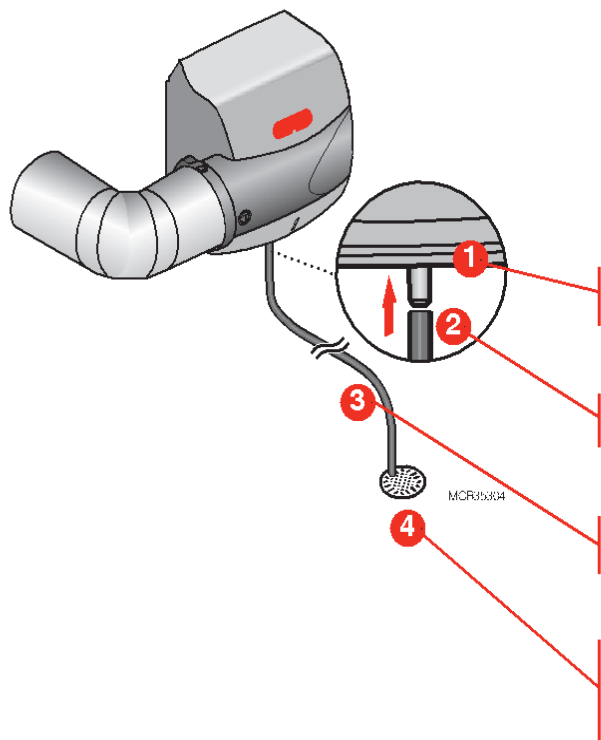

- Consult and follow local plumbing codes for drain pipe size and flow requirement.
- The ideal installation is directly to the main floor drain using the rubber hose provided.
- If direct floor drain access is not available, see *“Appendix C: Advanced Draining.”*

Connect the 1/2-in. drain hose provided to the drain fitting on the bottom of the humidifier.

Use the hose clamp provided to secure the drain hose to the fitting.

Route the drain hose to the floor drain. The hose must have a continuous downward slope.

Direct the hose outlet into the floor drain. Secure the hose to reduce the risk of water pooling or splashing as it drains from the humidifier.

Before proceeding to Wiring:

- ☐ I have connected the water supply line to the humidifier and the main water tap.
- ☐ I have installed the drain connection.
- ☐ I have checked all plumbing connections for leaks.

## Before Wiring the Humidifier



### CAUTION: Voltage Hazard.

Be sure the humidifier is not plugged in before beginning wiring.

Before wiring the humidifier:

☐ I understand and will comply with applicable local wiring codes and regulations.

### What humidifier model do I have?

The model number can be found on the bottom of the humidifier.

### STEP ONE: Remove the Humidifier Cover

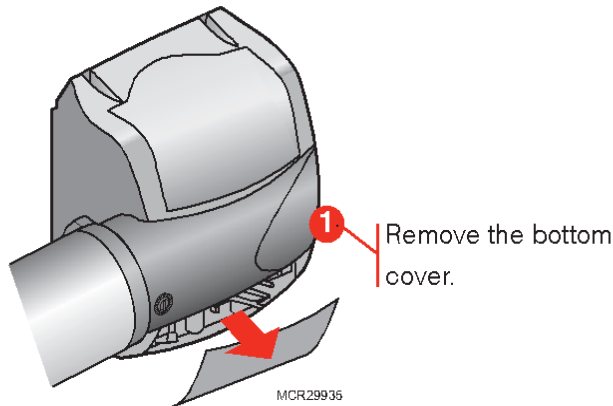

### Wiring TrueEASE to equipment with powered terminals.

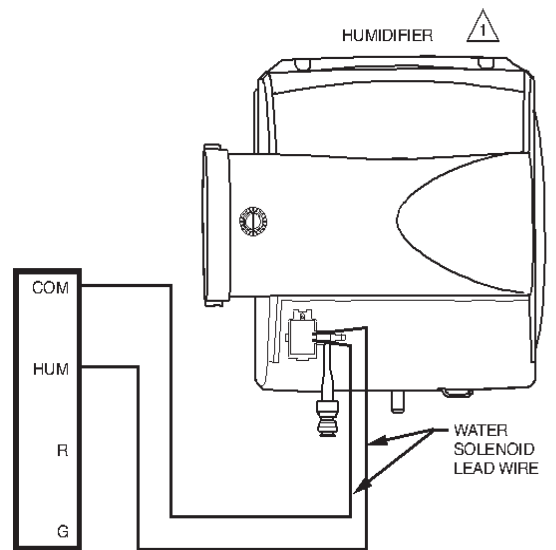

WIRING DIAGRAM ASSUMES THE USE OF EQUIPMENT-SPECIFIC COMMUNICATING THERMOSTAT CONTROLLING THE HUMIDIFIER.

M33039

### STEP TWO: Install the Transformer (Bypass Models)

Install transformer on the outside of a grounded metal junction box using only a 7/8 in. (22 mm) knockout hole. Place mounting tabs into the knockout hole and firmly tighten the locking screw. Field wiring connections and grounding means for the transformer and enclosure shall be in accordance with the National Electrical Code (NEC) and the Canadian Electrical Code (CEC). Connect wires to the 120V side of the transformer.

For HE150 and HE250, the 15V transformer must provide constant power to the 24V IN terminals.

### STEP THREE: Wiring the Humidifier

Use a wiring diagram from the following pages that matches your equipment.

When wiring is complete, run the wires coming out of the humidifier into the wiring clip on the bottom of the humidifier.

# Installing the Humidistat

## Duct Mount Installation

1. Choose a location on the **RETURN** duct.

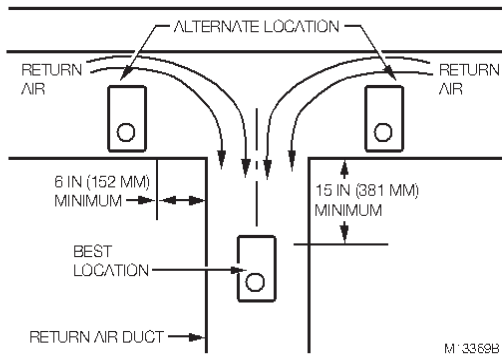

2. Apply sticker template to duct and drill holes for mounting screws. Cut along the dotted line of the template with metal shears or tin snips.

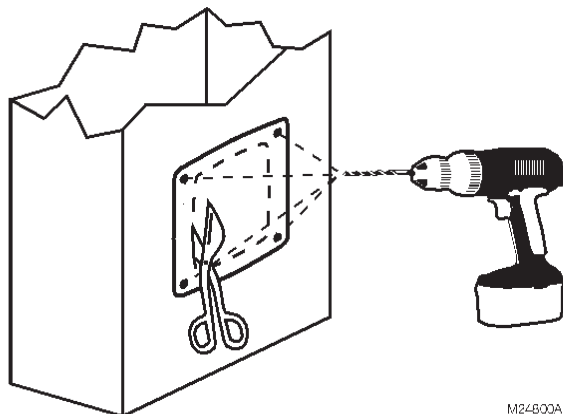

3. Run two-fan, low-voltage wire to the mounting location on the duct.

### IMPORTANT

Use rated 18-22 gauge wire. Leave approximately 6 in. of wire to properly connect the humidistat.

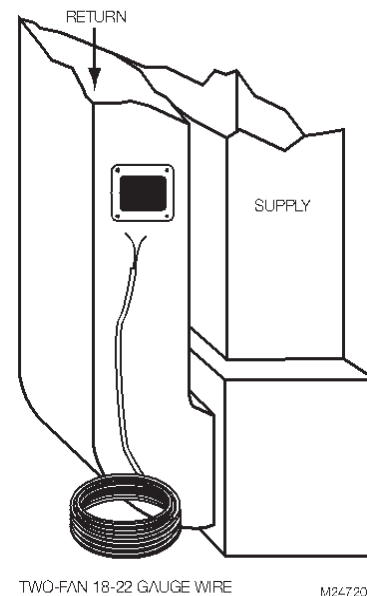

Go to step 4  
on the next page.

# Installing the Humidistat

## Remote Mount Installation

1. Choose a location in the living area.

**NOTE:** Select a location clear of drafts or excessive humidity. Avoid mounting near doors or windows, or in bathrooms or kitchens.

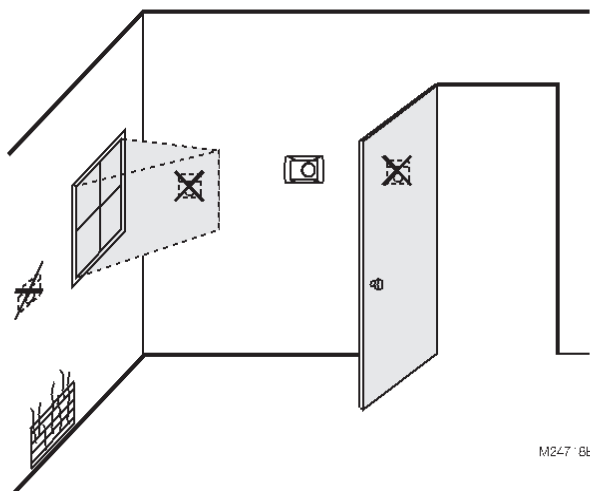

M247-6B

2. Cut 1 in. diameter wire hole in wall.
3. Run two-fan, low-voltage wire to the mounting location in the living area.

**IMPORTANT**

*Use rated 18-22 gauge wire. Leave approximately 6 in. of wire to properly connect the humidistat.*

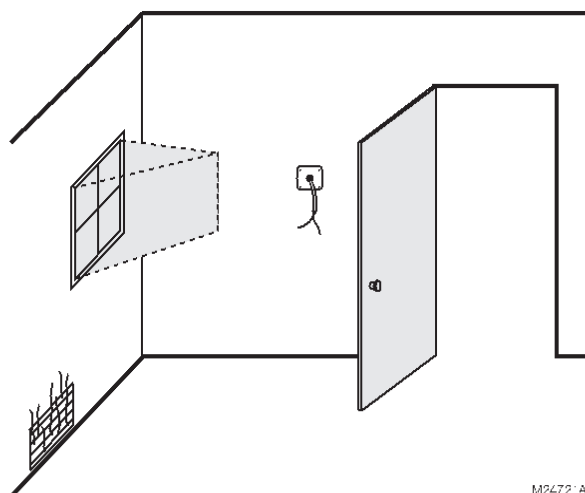

M2472-A

4. Remove the base bracket from the humidistat. For duct mount, slide the black gasket onto the base bracket.

**NOTE:** Use gasket only when mounting the control to ductwork. Leave off when mounting to a wall.

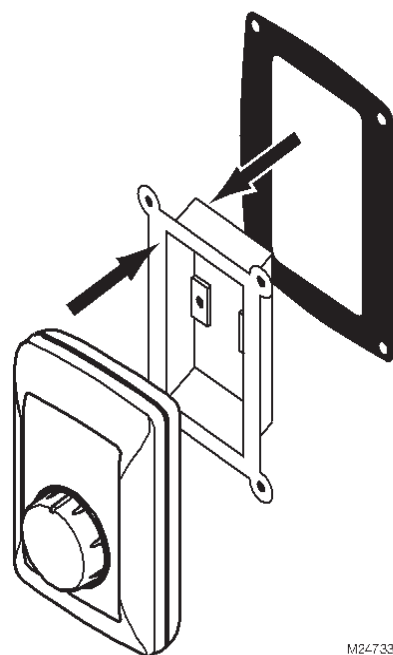

M24733A

5. Secure the base bracket to the duct or remote location. Secure to the duct with four 1-in. (25 mm) screws (provided) or to the wall with two 1-in. (25 mm) screws (provided).

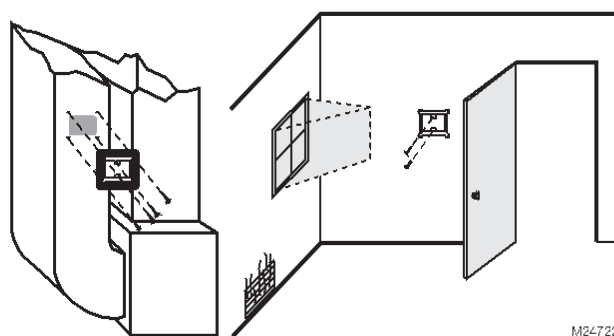

M24722A



# Installing the Humidistat

## Humidistat Wiring



**CAUTION: Personal Injury Hazard. Can cause electrical shock and injury.**  
Disconnect power before installation or servicing.

All wiring must comply with applicable local codes, ordinances and regulations. Make wiring connections according to humidifier (or dehumidifier/ventilator) instructions, if available; otherwise, see typical wiring diagrams on the next two pages.

### IMPORTANT

*Select models of fan centers include humidifier taps so the current sensing relay, sail switch or air pressure switch is not needed. If not using a current sensing relay, sail switch, or air pressure switch, the humidifier must be energized during blower motor cycles for proper operation.*

*On multispeed blower applications, do not wire the high voltage side of the transformer to the same power source that services the furnace blower. Premature transformer burnout can occur. On HE365 fan powered humidifier models, only the two yellow wires are connected to the control. The remaining two red wires are only used with electronic humidity controls.*

- Using wire nuts, connect the low-voltage wire to the leads on the H8908 humidistat. See the next two pages for different wiring configurations.

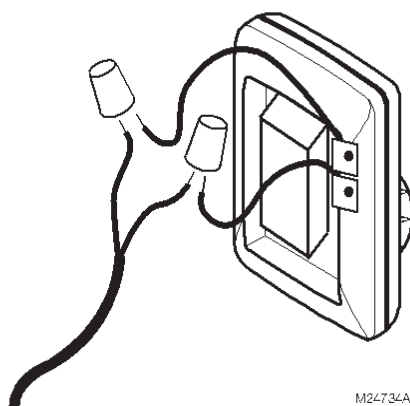

- Mount the humidistat by hooking the two hinges at the top of the back cover to the raised edge at the top of the base bracket. Press the bottom of the humidistat in to engage the base hinge. You will hear a "click" when the humidistat is secured.

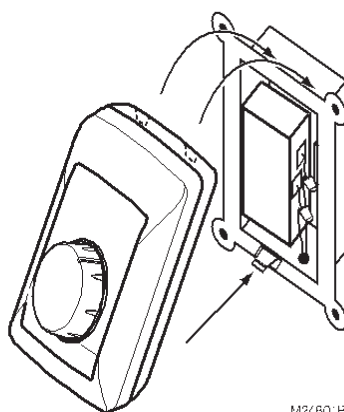

# Installing the Humidistat

## Humidistat Wiring

Wiring H8908 with fan interlock.

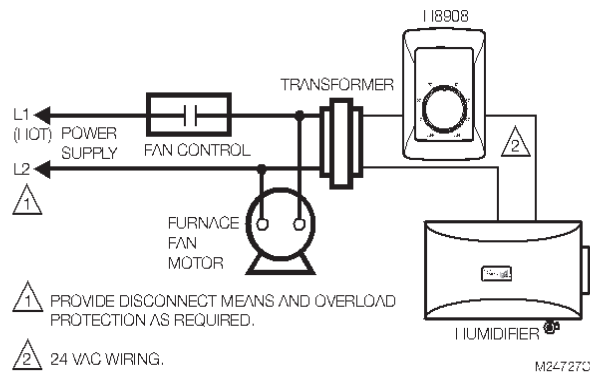

Wiring H8908 with 2-speed fan motor.

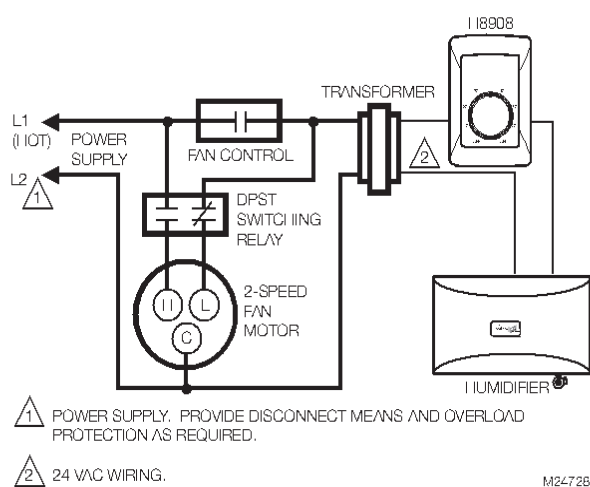

Typical wiring diagram of current sensing relay with humidifier.

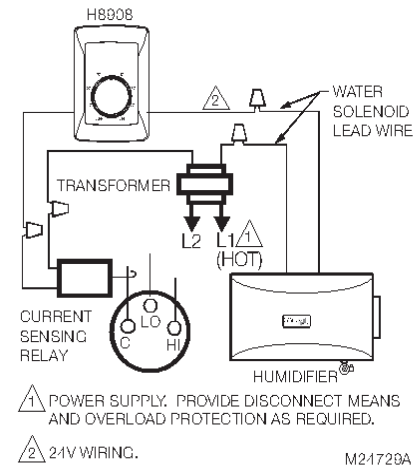

Wiring H8908 with steam humidifiers.

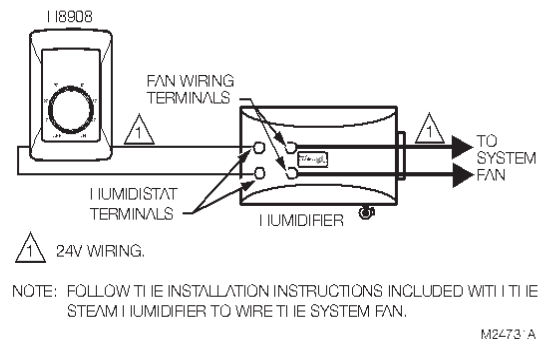

Wiring H8908 in line with air pressure switch/sail switch and humidifier.

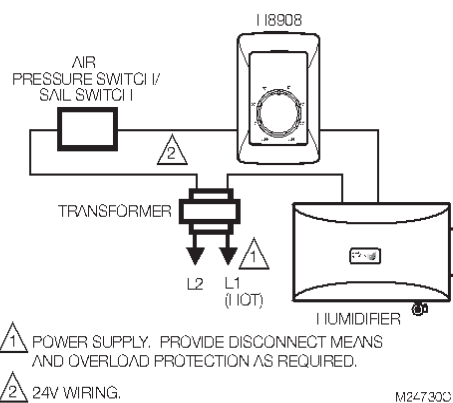

# Installing the Humidistat

## Humidistat Wiring

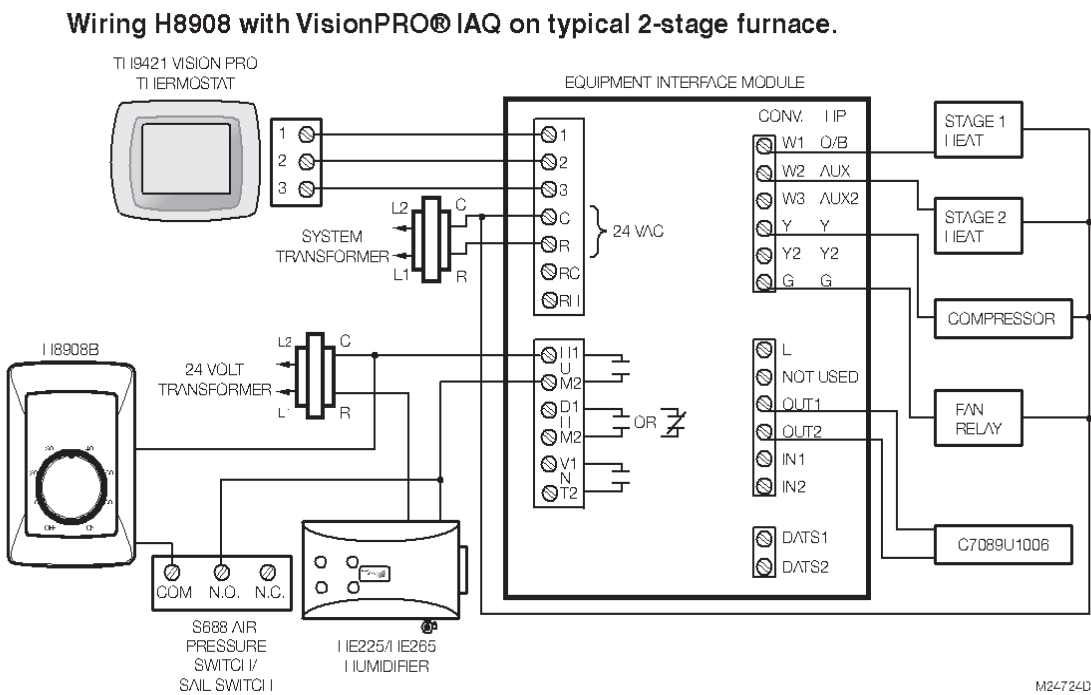

**Wiring H8908 with VisionPRO® Thermostat for dehumidification.**

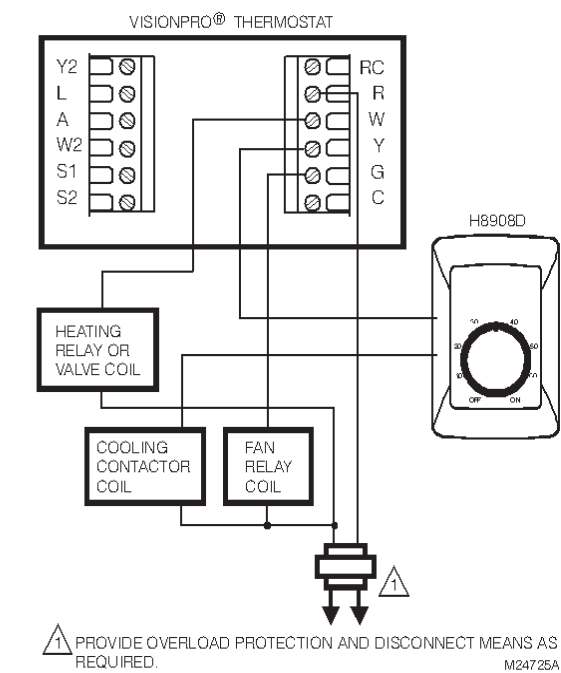

**Wiring TrueEASE to equipment with powered terminals.**

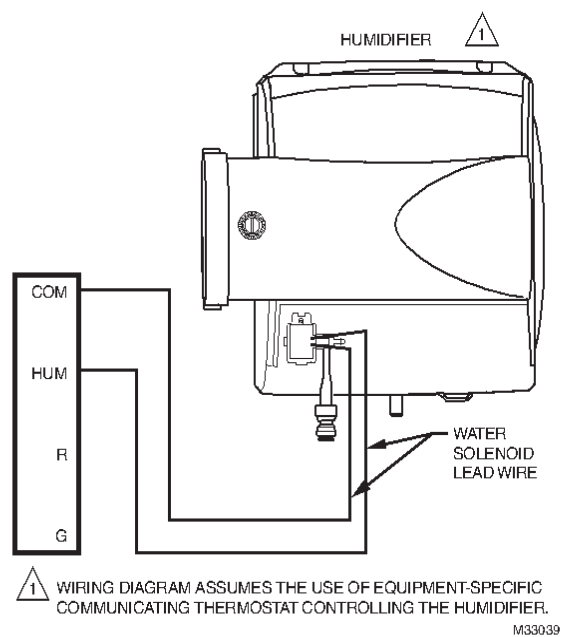

# Installing the Humidistat

## Humidistat Checkout

Turn the H8908 dial to “ON” to test proper installation.

You will hear an audible click if installed correctly, and water will begin flowing to the humidifier.

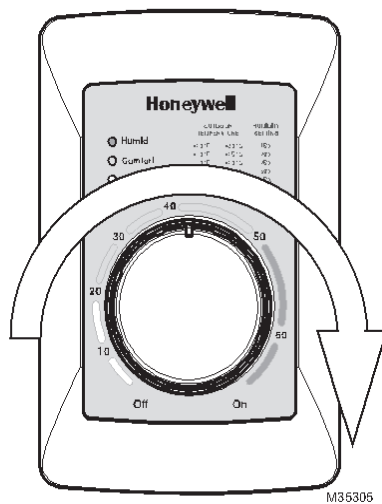

## Humidistat Operation

### Humidity Control Adjustment

To maintain optimal humidity levels without causing condensation on cold surfaces such as windows, the homeowner must adjust the setpoint as the outdoor temperature changes.

To reduce the relative humidity, lower the setpoint approximately three percent relative humidity every 24 hours. To increase the relative humidity, increase the setpoint approximately three percent relative humidity every 24 hours.

### Setpoint Adjustment

Set the humidity setpoint according to the prevailing outdoor temperature. Recommended settings are available on the control and in the table below.

Outdoor Temperature		Recommended H8908A,B Setpoints
°F	°C	
-20	-29	15
-10	-23	20
0	-18	25
+10	-12	30
+20	-7	35
>+20	>-7	40

Outdoor Temperature		Recommended H8908C,D Setpoints
°F	°C	
+70	+21	50
+75	+24	40
+80	+27	35
+85	+29	30
+90	+32	25
>+100	>+38	20

# Startup and Checkout

When installation is complete, follow the steps below. Make sure the humidifier is running properly before turning the system over to the homeowner. Once the humidifier is running, day-to-day operation is automatic. The homeowner can use the control to adjust the humidity levels and turn the humidifier on or off.

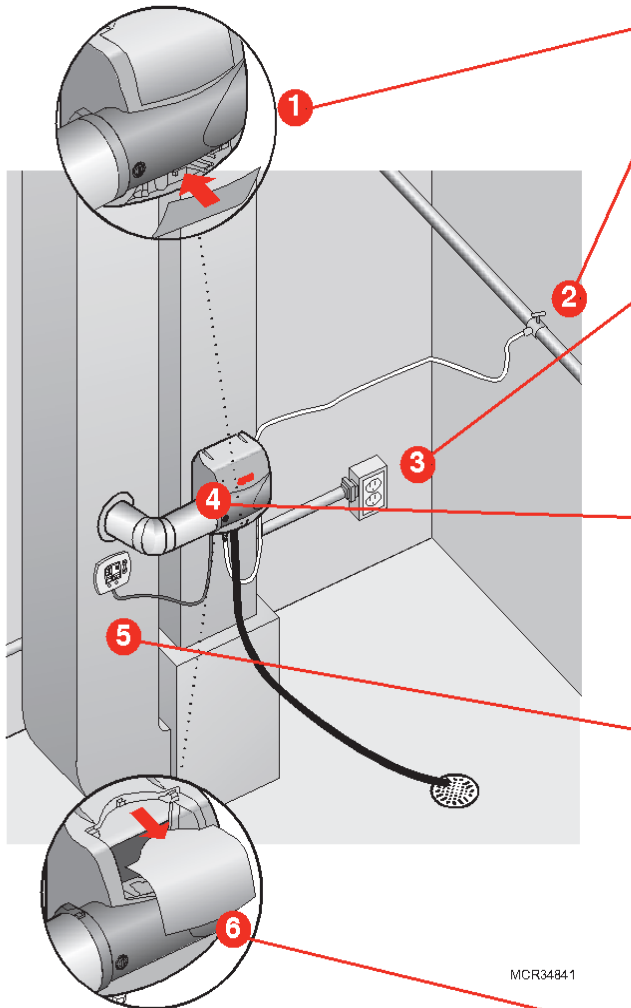

Snap the bottom cover into place.

Turn on the water supply at the saddle valve or T-fitting and manual shutoff valve. Water will flow to the humidifier but will not pass through the pad until the humidity control is turned on.

Apply HVAC system power (HE100/HE150/HE200/HE250)

On HE100/HE200, turn the Damper Position knob on the bypass outlet so that it is parallel to the bypass outlet. On HE150/HE250, the humidifier does this automatically.

Turn the humidity control to On.

- If your wiring is configured for operation only with heat or fan, make the appropriate system demands to allow humidification.
- Make sure air is blowing through the ductwork with the humidifier call.

The Humidifying light will be solidly on when water is flowing through the humidifier pad

- On HE150/HE250 models, remove the humidifier's top cover to verify water flow through the top tray and into the pad. Make sure that the damper rotates open when humidity is on, and rotates closed when humidity is off.

Check all water line and drain connections to ensure there are no leaks before leaving the job site.

- Check for leaks immediately after turning the main water supply on, and again after 15 minutes of humidifier operation.

Turn the setpoint to the homeowner's desired level when testing is complete. If humidity is not needed, set the control to Off, and turn the Damper Position knob on the bypass outlet so that it is perpendicular to the bypass outlet (HE100/HE200 only).

## Routine Maintenance

It is recommended that the humidifier pad be replaced once per year. This can be done at the beginning or the end of the dry season. The humidifier design makes this annual replacement quick and easy, providing one-step access to the pad.

### Bypass:

1. Pad can be replaced from the side by gripping the black handle and pulling out, or from the front by removing the humidifier's top cover and rocking the pad forward and out. Humidifier pad might remove from other side of humidifier, depending on installation.

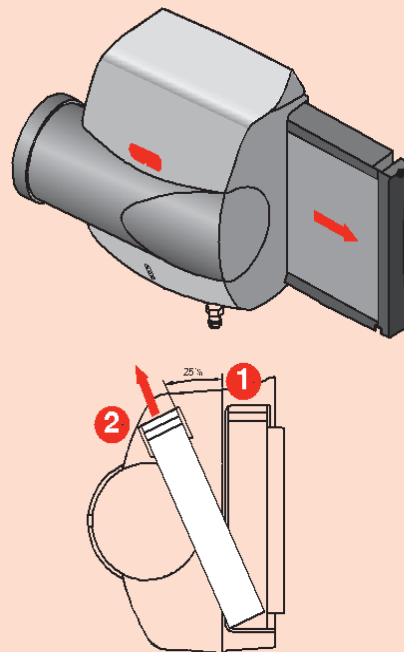

2. Remove tray on top of the pad, and wipe free any sediment present within the tray.
3. Replace the old pad with the new, making sure pad is oriented correctly (see pad box). Wipe free any sediment present inside the pad frame.
4. Reseat the tray on top of the pad with the arrows inside the tray pointing into the duct. Then reinsert the frame into the humidifier.
5. After pad replacement is complete, remove the bottom cover and press the RESET button to reset the maintenance timer.

# Troubleshooting

Problem	What To Look For	What To Do
Low humidity	Furnace blower not operating	<ol style="list-style-type: none"> <li>1. Reset circuit breaker or check for blown fuse.</li> <li>2. Check that the furnace power is on.</li> <li>3. Check all external wiring connections.</li> <li>4. Check the humidity control setting.</li> </ol>
	Rapid air changes or drafts	<ol style="list-style-type: none"> <li>1. Keep doors and windows closed.</li> <li>2. Close fireplace damper when not in use.</li> <li>3. Keep exhaust fan running time to a minimum.</li> <li>4. Seal around doors and windows.</li> </ol>
High humidity	Condensation on walls	<ol style="list-style-type: none"> <li>1. Turn off humidity control and water until condensation is completely evaporated.</li> </ol>
	Heavy condensation on windows	<ol style="list-style-type: none"> <li>1. Turn humidity control down low enough to eliminate condensation caused by moisture. If moisture persists, more ventilation is needed.</li> </ol>
Replace Pad light is on (HE 150/HE250/ HE300)	This is the yearly maintenance reminder to replace the pad inside the humidifier	<ol style="list-style-type: none"> <li>1. Refer to the parts list and replace the pad for your humidifier model.</li> <li>2. Once pad is replaced, press the RESET button under the wire cover.</li> </ol>

# A: Specifications

## Humidifying Capacity

At 120°F (49°C) plenum temperature and 0.20 static pressure drop across supply and return:  
HE100/150: up to 12 gallons per day (gpd)  
(46 liters per day [lpd])  
HE200/250: up to 17 gpd (65 lpd)

## Humidified Area

HE100/150: Up to 16,000 cubic feet  
HE200/250: Up to 20,000 cubic feet

## Dimensions

HE100/150: 14.5 in. W x 14 in. H x 10.1 in. D  
(368 mm W x 356 mm H x 257 mm D)  
HE200/250: 15 in. W x 17.15 in. H x 10.1 in. D  
(381 mm W x 436 mm H x 257 mm D)

## Humidifier Pad Dimensions

HE100/150: 9-1/2 in. W x 9-13/16 in. H x 1-1/2 in. D  
(241 mm W x 249 mm H x 38 mm D)  
HE200/250: 10 in. W x 13 in. H x 1-1/2 in. D  
(254 mm W x 330 mm H x 38 mm D)

## Static Pressure

HE100/150/200/250: Supply plenum static pressure no greater than .3 in. w.c.

## Plenum Opening Dimensions

HE100/150: 9-5/16 in. W x 9-7/16 in. H (238 mm W x 241 mm H)  
HE200/250: 9-3/4 in. W x 12-5/8 in. H (248 mm W x 321 mm D)

## Bypass Duct Opening Dimensions (HE100/150/200/250)

6 in. (152 mm)

## Operating Ranges

34°F–90°F (1.1°C–32°C)  
Humidity: 0–95% RH, non-condensing

## Drain Fitting

1/2 in. (13 mm) I.D. plastic hose connected directly to drain fitting on unit.

## Electrical Ratings and Tolerances

HE100/200: 24VAC, 60 Hz, 0.5 A maximum



## Humidifier 33-00067EF—01

- Pump with (140°F temperature rating, > 5 GPH pump flow rate, with 9-foot rise).
- Pump must be powered when humidifier is operating.
- Use a pump with a built-in overflow sensor or install the in a drip pan with wet switch wired to turn off humidifier.

ALL CONNECTIONS MUST BE SWEAT, FLARED OR WELDED TO DRAIN TRAP ARE SEALED

12 IN. MNPT X SWEAT  
12 IN. FNPT X 1-1/2 IN. PVC

1/2 IN. PVC

12 IN. MNPT X 1-1/2 IN. CPVC  
12 IN. FNPT X 1-1/2 IN. PVC

HOSE CLAMP  
3/8 IN. BARB X 3/4 IN. MNPT  
12 IN. FNPT X 1-1/2 IN. PVC

SIZE TO FIT PUMP OUTPUT

ALTERNATIVE  
THIS CONFIGURATION ALLOWS FOR REMOVAL OF THE TRAP

ALL PLASTIC PIPE UNDER SINK  
1-1/2 IN. MINIMUM PVC

1-1/2 IN. CPVC

1-1/2 IN. FNPT

1-1/2 IN. PVC

COUPLING  
WELD  
WYE  
THREADS

WELD  
WELD  
THREADS

SINK

STAINLESS STEEL—  
SLOTTED BAND  
COUPLING SIZED TO  
FIT PIPE (COPPER,  
PVC, CPVC)

- Support rubber hose every 6 in.
- PVC must be schedule 40 or higher rating.
- All plastic pipe joints are welded.
- Drain into a P-trap that will remain wetted at all times.

SEAL ALL CONNECTIONS FROM SOLENOID VALVE TO DRAIN STACK

**A** 1/2 IN. FNPT X SWEAT 1/2 IN. COPPER PIPE

**B** 1/2 IN. FNPT X 1/2 IN. PVC

**C** 1/2 IN. (MINIMUM) PVC PIPE 1/2 IN. FNPT X 1/2 IN. FNPT CPVC PIPE

**D** 1/2 IN. FNPT X 1/2 IN. FNPT CPVC PIPE 1/2-IN. TUBING RATED AT 140°F

140°F RATED PUMP & SOLENOID RATE WITH 9-FT. RISE

HOSE FROM HUMIDIFIER

HOSE CLAMPS

1/2 IN. BARB X 1/2 IN. FNPT

FLEXIBLE HOSE

Diagram illustrating four methods (A, B, C, D) for venting a pump to the atmosphere, all requiring a 1-1/2 in. minimum trap (or size per local code) and vented per local code.

- A:** 1/2 in. MNPT X SWEAT - 1/2 in. FNPT X 1-1/2 in. PVC
- B:** 1/2 in. (MINIMUM) PVC PIPE - 1-1/2 in. PVC
- C:** 1/2 in. MNPT X 1/2 in. CPVC - 1/2 in. FNPT X 1-1/2 in. PVC
- D:** HOSE CLAMP - 1/2 in. BARB X 1/2 in. MNPT - 1/2 in. FNPT X 1-1/2 in. PVC

ALL PLASTIC PIPE JOINTS ARE WELDED

1-1/2 IN. MINIMUM TRAP (OR SIZE PER LOCAL CODE)

VENTED PER LOCAL CODE

SIZE TO FIT PUMP OUTPUT

[illegible]

C: Parts List

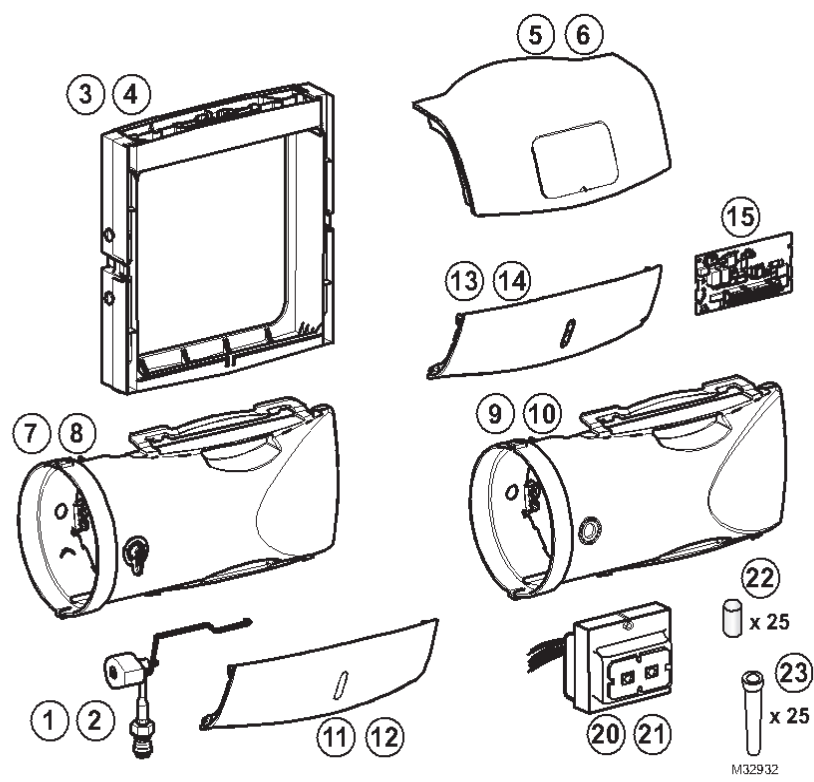

Figure Reference	Part Number	Part Description	Use With Model
N/A	HC26E1004	Large AglON coated replacement pad	HE200, HE250
N/A	HC26A1008	Large standard replacement pad	HE200, HE250
N/A	HC22E1003	Small AglON coated replacement pad	HE100, HE150
N/A	HC22A1007	Small standard replacement pad	HE100, HE150
N/A	32001616-001	Saddle valve	HE100, HE150, HE200, HE250
1	50041883-002	AC Solenoid valve	HE100, HE200
2	50041883-001	DC Solenoid valve	HE150, HE250
3	50041861-001	Frame and tray assembly for small bypass model	HE100, HE200
4	50041861-002	Frame and tray assembly for large bypass model	HE150, HE250
5	50052641-001	Top cover for small bypass model	HE100, HE150
6	50052641-002	Top cover for large bypass model	HE200, HE250
7	50041888-001	Small bypass duct with manual damper	HE100
8	50041888-002	Large bypass duct with manual damper	HE200
11	50041886-001	Bottom cover for small basic bypass model	HE100
12	50041887-001	Bottom cover for large basic bypass model	HE200
20	32001652-001	10V transformer	HE100, HE200
22	50032048-002	Qty 25 Residential humidifier quick connect adapter	HE100, HE150, HE200, HE250
23	32001647-001	Qty 25 Residential humidifier cone screen filter	HE100, HE150, HE200, HE250