

PGH Portable Garage/Shop Heater

FEATURES

- 240 Volt—4800W Utility Heater.
- Built-in thermostat (45°-85°) and On/Off rocker switch.
- Power Indicator Light.
- Auto Reset Fan Delay—Increases efficiency.
- 333 CFM.
- Auto Reset Thermal Cutout—Ensures heater shut-off in an unsafe condition.
- 6' Power cord with 30 Amp plug.
- Convenient handle w/built-in cord storage.
- Durable scratch and rust resistant finish.
- Stainless Steel Tubular Heating Element.
- Mounting bracket for wall or ceiling installation included.
- 1-year warranty against manufacturing defects.



The PGH is a high wattage portable heater designed to provide a back-up heating source at an affordable price. Perfectly suited for the workshop, garage or construction sites, the rotation capability. The convenient 6 foot cord allows greater mobility to areas needing heating, while the handle serves as a reel for the cord when not in use. Easily set the desired temperature with the built-in thermostat. Sure stop high-limit temperature control with auto-reset provides overheat protection. 1 year warranty.

MODEL	UPC# 093319 PART #	DESCRIPTION
PGH2448TB	20984	4800W, 240V, 1-Phase with Thermostat

Easy Installation

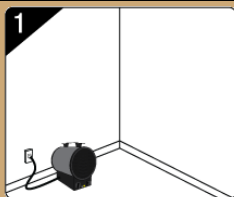

Portable Application

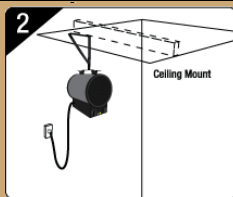
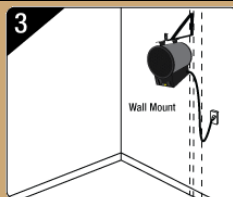
Mount bracket to
ceiling joist and attach
heater

Mount bracket to wall
stud and attach heater

SPECIFICATIONS

BTU	16,400
Watts	4800 W
Heating Area (ft2)	516 ft2
Power (Volts)	240V~60Hz
Amps	20A
Heat Settings 1	On/Off
Heat Settings 2	Thermostat

Minimum Clearance From Combustibles

Front	3 ft.
Top	1 ft.
Sides	1 ft.
Rear	1 ft.

Plug Type
30 Amp 250 V
NEMA #6-30R