



CW-300

The Robertshaw® N-51 Mixing Water Valve Series is designed for laundry clothes washer applications where flow control is required.

### Features and Benefits

- Dual solenoid valve with a pilot-operated diaphragm that provides high flow capacity with minimum power requirements
- Encapsulated coil provides high mechanical and dielectric strength, and is moisture resistant
- Unique diaphragm design reduces unwanted particles from entering the armature area
- Armature is designed with clearances to minimize jamming due to foreign materials
- Bodies are made of polypro which provides high resistance to corrosion and mineral deposits
- Suitable for applications using water at temperatures up to 160°F (71°C)
- Water hammer suppression
- Includes stainless steel inlet screens with 50 x 40 mesh (50 x 40 holes/inch in both x and y directions)

### REPLACEMENT INFORMATION

Part Numbers	Replaces	Factory Number
CW-300	Electrolux	K-67914



## N-51 SERIES

## WATER VALVES

Part Numbers	Description	Flow Rate	Inlet	Outlet	Operating Pressure	Terminals	Body Material	Electrical Rating	Power
CW-300	Residential Clothes Washer Mixing Water Valve N-51	3.0 GPM to 14.6 GPM	3/4" 11 NHT	1/2" ID Hose	30 PSI to 120 PSI	Plain Brass	Polypro (Brown)	120V AC 60 Hz	10 Watts

### PRODUCT DRAWINGS

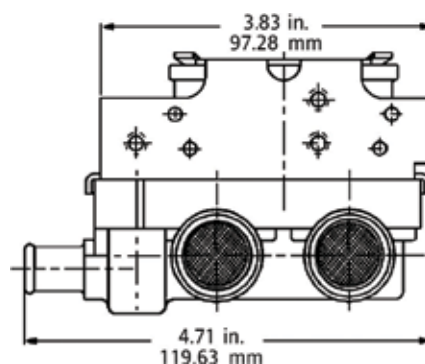
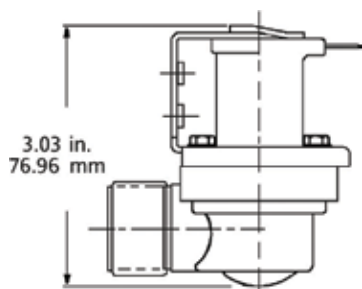
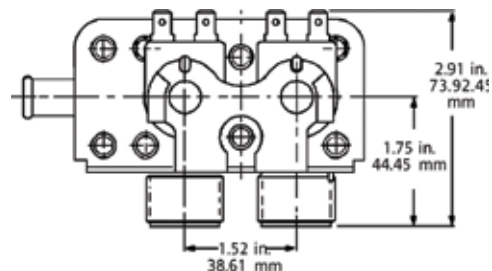
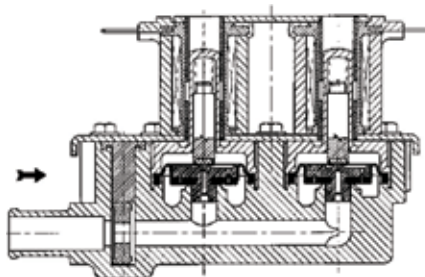
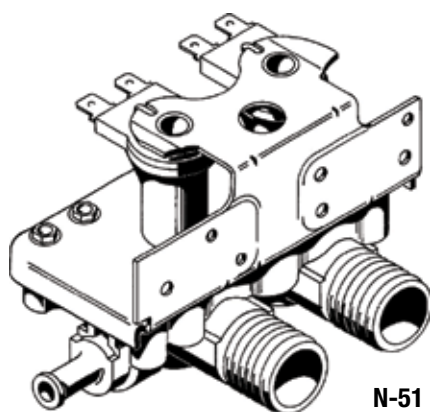

## UNI-LINE®

191 E. North Avenue  
Carol Stream, Illinois 60188 USA  
Customer Service Telephone 1.800.304.6563  
Customer Service Facsimile 1.800.426.0804  
HVACCustomerService@Invensys.com

For Technical Service  
Telephone 1.800.445.8299  
Facsimile 1.630.260.7294  
TechnicalService@Invensys.com

Uni-Line® and Robertshaw® are trademarks of Robertshaw Controls Co. its subsidiaries and/or affiliated companies. All other brands mentioned may be the trademarks of their respective owners.

[www.Uni-Line.com](http://www.Uni-Line.com)  
[www.InvensysControls.com](http://www.InvensysControls.com)  
©2014 Robertshaw Controls Co.  
03/14 – 150-2440