

IMV-0402

The Robertshaw® S-53 Water Valve Series is a single solenoid valve for dishwashing machines and commercial icemakers. The S-53 features the design combination of a brass inlet fitting and a mounting bracket, which allows direct connection to the supply plumbing without applying torque to the valve body.

### Features and Benefits

- Pilot-operated diaphragm provides high flow capacity with minimum power requirements
- Unique diaphragm design reduces unwanted particles from entering the armature area
- Armature is designed with clearances which minimize the possibility of jamming due to foreign materials
- Bodies are made of polypro to withstand a variety of harsh water conditions
- Suitable for applications using water at temperatures up to 160°F (71°C)

### REPLACEMENT INFORMATION

Part Numbers	Replaces	Factory Number
IMV-0402	Manitowoc 000000402	K-76167-10
IMV-2201	Scotsman 12292201	K-74118-27



## S-53 SERIES

## WATER VALVES

### SPECIFICATIONS

Part Numbers	Description	Flow Rate	Inlet	Outlet	Operating Pressure	Terminals	Body Material	Electrical Rating	Power
IMV-0402	Commercial Ice Machine Water Valve S-53	0.75 GPM to 3.00 GPM	3/8" 18 FNPT	3/8" ID Hose (Yellow)	20 PSI to 120 PSI	1/4" Male	Polypro	240V AC 50/60 Hz	10 Watts
IMV-2201	Commercial Ice Machine Water Valve S-53	1.25 GPM	3/8" 18 FNPT	3/8" ID Hose	20 PSI to 120 PSI	1/4" Male	Polypro	120V AC 50/60 Hz	10 Watts

### PRODUCT DRAWINGS

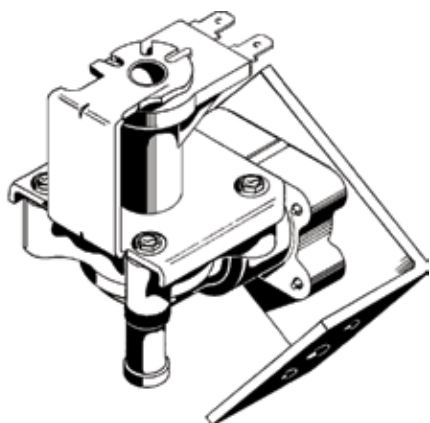

S-53

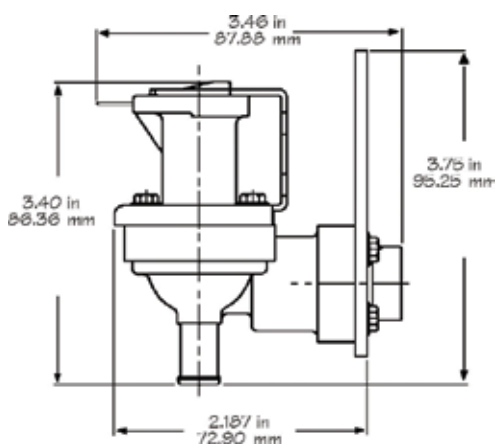
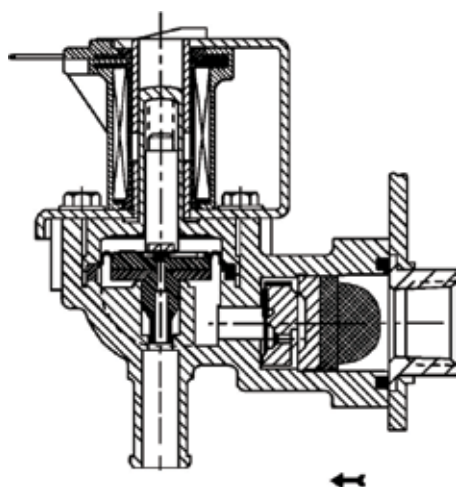
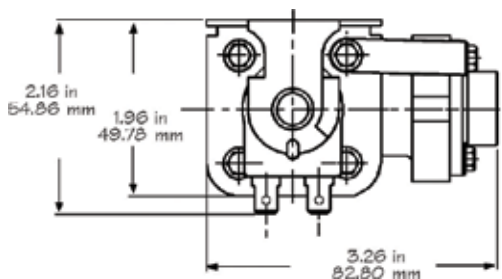

**UNI-LINE®**

191 E. North Avenue  
Carol Stream, Illinois 60188 USA  
Customer Service Telephone 1.800.304.6563  
Customer Service Facsimile 1.800.426.0804  
HVACCustomerService@Invensys.com

For Technical Service  
Telephone 1.800.445.8299  
Facsimile 1.630.260.7294  
TechnicalService@Invensys.com

Uni-Line® and Robertshaw® are trademarks of Robertshaw Controls Co. its subsidiaries and/or affiliated companies. All other brands mentioned may be the trademarks of their respective owners.

[www.Uni-Line.com](http://www.Uni-Line.com)  
[www.InvensysControls.com](http://www.InvensysControls.com)  
©2014 Robertshaw Controls Co.  
03/14 – 150-2435