

### SpinTec™ Showerhead Replacement Parts

- Includes integral 22gpm flow restrictor
- Fully distributes water throughout spray pattern
- Compact design minimizes footprint in your facility



□ **S24-192**  
Plastic shroud and ring  
(showerhead not included)



□ **S24-193**  
Stainless steel shroud and ring  
(showerhead not included)



□ **S24-194**  
Plastic showerhead and 1"  
diameter 90° elbow



□ **S24-200**  
Stainless steel showerhead and  
1" diameter 90° elbow



□ **S24-195**  
Plastic shroud with ring, plastic  
showerhead and 1" diameter 90° elbow



□ **S24-196**  
Stainless steel shroud with ring, plastic  
showerhead and 1" diameter 90° elbow



□ **S24-202**  
Plastic showerhead, white steel in-ceiling recessed shroud  
assembly, ring, coupling and 1" diameter 90° elbow



□ **S154-147**  
Ring only

### Safety Signs and Tags



□ **114-050**  
Drench shower sign



□ **114-051**  
Eyewash sign

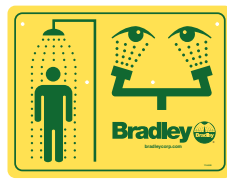

□ **114-052**  
Combination Drench  
shower and eyewash sign

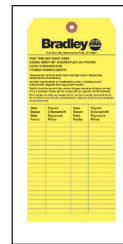

□ **204-421**  
Inspection Tag  
(sold individually)

### Eyewash Bowls



□ **154-058**  
Impact-resistant  
plastic eyewash  
bowl, 10" diameter



□ **187-053**  
Corrosion-resistant  
stainless steel bowl,  
10 3/4" diameter

### Dust Caps

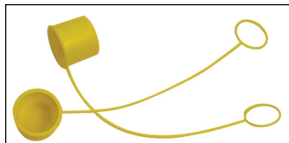

□ **107-371**  
Eyewash dust caps only (sold  
individually; two required per  
eyewash). Yellow plastic tether.  
Approximately 1" x 1".



□ **S53-063**  
Dual Eye/Face wash dust  
caps only (sold individually;  
two required per eyewash).  
Beaded chain tether, 2 1/4" x 1".



□ **S53-310**  
Eyewash dust cap (sold  
individually; two required  
per eyewash). Beaded  
chain tether, 1" x 1".

### Touch-Up Paint



□ **269-964**  
Safety yellow touch-up paint.  
12-oz. aerosol

## On-Site® Accessories and Water Preservative



### □ S19-949 On-Site Eyewash Refill Kit

Includes replacement cap, nine foam liners, inspection tag

### □ 269-1379 On-Site Water Foam Liner

Perforated foam liner (sold individually)



### □ S19-921HR On-Site Heater Jacket Retrofit Kit (pedestal not included)

- Protects against freezing down to -20°F (-29°C)
- Insulated heater jacket conceals a 121-watt heater
- Secondary thermostat prevents overheating if primary thermostat fails
- All UL-listed components; requires 120-volt AC



### □ S19-399 On-Site Waste Cart

- High-visibility yellow
- Captures used fluid; 56-gallon capacity
- Tapered sump, easy to drain

## Sprayhead and Spray Ring Assemblies

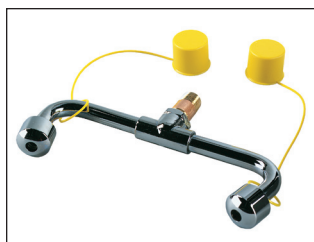

### □ S39-394

Eyewash sprayhead assembly with supply stem



### □ S39-396

Eye/face wash sprayhead assembly with supply stem



### □ S39-681

Eye/face wash sprayhead assembly; stem not included



### □ S05-135

Eye/face wash (sprayhead only; sold individually). Includes 2.4 GPM flow control inside each head. Total flow from dual heads is 4.8 gpm



### □ S39-397

Eyewash and spray ring assembly with supply stem



### □ S05-127

Spray ring only; requires cross-connection yoke for attachment to eyewash

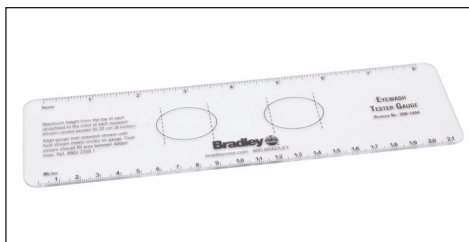

### □ 269-1444

Eyewash test gauge

## Eyewash Ball Valves, Handles and Hardware



- **S45-122**  
Plastic eyewash handle with 1/2" NPT stay-open ball valve and hardware

- **S45-123**  
Plastic eyewash handle with hardware

- **128-135**  
Plastic eyewash handle only

- **S27-282**  
Brass 1/2" NPT stay-open ball valve only



- **S30-070**  
Stainless steel eyewash handle with 1/2" NPT stay-open ball valve and hardware

- **S30-071**  
Stainless steel eyewash handle with hardware

- **S08-336**  
Stainless steel eyewash handle only

- **S27-282**  
Brass 1/2" NPT stay-open ball valve only



- **S30-072**  
For stainless steel hinged dust covers only. Stainless steel eyewash handle with 1/2" NPT stay-open ball valve and hardware

- **S30-087**  
For stainless steel hinged dust covers only. Stainless steel eyewash handle with hardware

- **S27-282**  
Brass 1/2" NPT stay-open ball valve only



- **S30-074**  
For S19-270BL (left-hand) eyewash only. Stainless steel eyewash handle with 1/2" NPT stay-open ball valve and hardware

- **S30-075**  
For S19-270BL (left-hand) eyewash only. Stainless steel eyewash handle with hardware

- **S27-282**  
Brass 1/2" NPT stay-open ball valve only



- **S08-338**  
For all-stainless steel units only. Stainless steel eyewash handle



- **S27-287**  
Stainless steel 1/2" NPT stay-open ball valve

## Drench Shower Ball Valves, Handles and Hardware



- **S30-059**  
Chrome-plated brass 1" NPT ball valve with lever

- **S27-278**  
Chrome-plated brass 1" NPT ball valve only

- **S30-061 (not shown)**  
Stainless steel 1" NPT ball valve with lever

- **S27-276 (not shown)**  
Stainless steel 1" NPT ball valve only

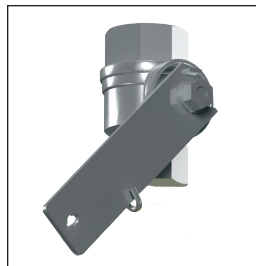

- **S19-0011**  
Self-closing ball valve  
*NOTE: Self-closing ball valves are not ANSI Z358.1 compliant Appendix B3. However an exception may be made in a 'school laboratory' situation. Contact local authorities regarding specific application*



- **128-156A**  
Drench shower handle for standard (non-barrier-free) units (25 1/2" x 9")

- **128-156B**  
Drench shower handle for flush-mount (non-barrier-free) units (36" x 9")

- **128-156G**  
Drench shower handle for heat trace units (27" x 9")

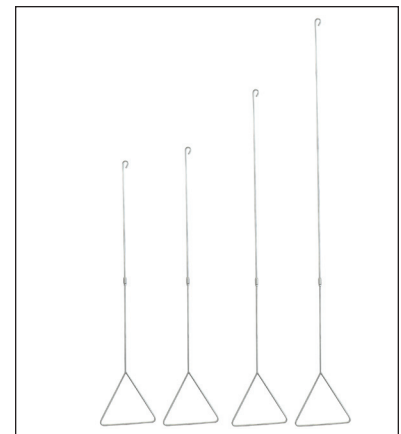

- **128-156D**   
Drench shower handle (standard; shipped with barrier-free showers) (45 1/2" x 9")

- **128-156C**   
Drench shower handle (48" x 9")

- **128-156E**   
Drench shower handle (57" x 9")

- **128-156F**   
Drench shower handle (69" x 9")

## Foot Treadle Kits



### □ S45-572

Foot treadle and hardware kit (with 3-foot chain) for standard pedestal-mounted eyewashes and combination shower/eyewash units with hand operation; provides supplemental foot operation

### □ S45-1314SS

Type 304 stainless steel foot treadle and hardware kit for stainless steel pedestal-mounted eyewashes and combination shower/eyewash units

### □ S45-1314SS16

Type 316 stainless steel foot treadle and hardware kit for Type 316 stainless steel pedestal-mounted eyewashes and combination shower/eyewash units

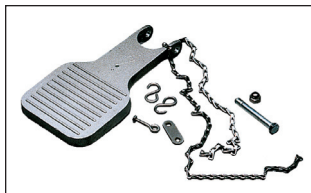

### □ S45-1544

Foot treadle and hardware kit (with 3½-foot chain) for European units with hand operation; provides supplemental foot operation

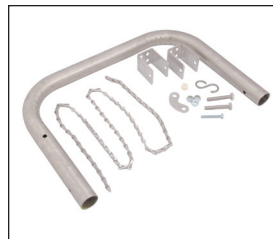

### □ S39-395

Foot treadle and hardware kit for wall-mounted eyewashes with hand operation; provides supplemental foot operation

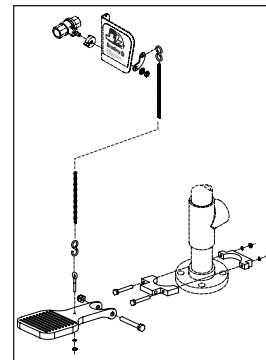

### □ S45-620

Foot treadle and hardware kit for model S19-310PVC combination drench shower and eyewash unit with hand operation; provides supplemental foot operation

## Drench Hose Spray Kits and Replacement Parts



### □ S19-430EH

Drench hose spray kit with valve, drench hose sprayhead, hose, inspection tag and hardware. For use with eyewashes; provides a body water drench

### □ S19-787

Replacement valve/drench hose sprayhead only

### □ S27-265

Replacement valve only



### □ S19-430SH

Drench hose spray kit with valve, drench hose sprayhead, hose, inspection tag and hardware. For use with drench showers; provides a body water drench

### □ S19-787

Replacement valve/drench hose sprayhead only

### □ S27-265

Replacement valve only



### □ S89-002

8' thermoplastic hose; yellow

### □ S89-003

6' stainless steel hose



### □ 269-053

12' thermoplastic hose; yellow



### □ 269-054

25' thermoplastic hose; yellow

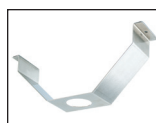

### □ 140-226

Drench hose guide bracket

## Backflow Prevention



### □ S27-303

Dual-check backflow preventer compliant with ASSE 1024 & CSA B64.6 Watts Series 7



### □ S45-2309

Dual-check vacuum breaker compliant with CSA B64.6 Watts Series 9



### □ S45-2310

Dual-check backflow preventer compliant with ASSE 1012 Watts Series 9D; includes fittings for easy installation

## Stem Assemblies, Spacers and Flow Restrictors

Sprayhead Assembly	Galvanized Fixture with Plastic Bowl	Galvanized Fixture with Stainless Steel Bowl	Standard Stainless Steel Fixture	316 Stainless Steel Fixture
Eyewash Only	S21-071 (stem) 113-1185 (stem spacer)	S21-071 (stem) 113-1159 (stem spacer)	S21-072 (stem) 113-1159 (stem spacer)	S21-075 (stem) 113-1159 (stem spacer)
Eye/Face Wash with Spray Ring	S21-073 (stem) 113-1185 (stem spacer)	S21-073 (stem) 113-1159 (stem spacer)	S21-074 (stem) 113-1159 (stem spacer)	None
Eye/Face Wash with Dual Black Heads	113-1150 (stem)	113-1150 (stem)	113-1151 (stem)	None

☒ Spacers 113-1159 and 113-1185 are required for units that shipped on or before 11/2/2005.

## Stem Assemblies



- ☐ **S21-071**  
Brass stem assembly with flow restrictor; **for units with eyewash only**
- ☐ **113-1150**  
Brass stem only; **for units with dual black eye/face wash heads**



- ☐ **S21-072**  
stainless steel stem assembly with flow restrictor; **for stainless steel units with eyewash only**
- ☐ **S21-075**  
316 stainless steel stem assembly with flow restrictor; **for 316 stainless steel units (with eyewash) only**
- ☐ **113-1151**  
stainless steel stem only; **for stainless steel units with dual black eye/face wash heads**



- ☐ **S21-073**  
Brass stem assembly with flow restrictor; **for units with eyewash and spray ring only**



- ☐ **S21-074**  
stainless steel stem assembly with flow restrictor; **for stainless steel units with eyewash and spray ring only**



**S21-036 / S21-050**

## Stem Spacers



- ☐ **113-1159**  
Stainless steel stem spacer; for use in units with stainless steel bowl



- ☐ **113-1185**  
Black plastic stem spacer; for use in units with yellow plastic bowl

## Eyewash and Eye/Face Wash Flow Restrictors



- ☐ **125-164**  
2.64 GPM yellow flow restrictor; **for eyewash only** (stem not included)

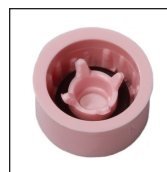

- ☐ **125-167**  
3.7 GPM pink flow restrictor; **for eyewash with face spray ring only** (stem not included)



- ☐ **125-032**  
3.5 GPM black flow restrictor; for swing-activated and swing-down units



## Thermostatic Mixing Valves



### □ S19-2000

8 GPM @ 30 PSI;  
accommodates up to  
three eyewashes or  
one eye/face wash



### □ S19-2100

36 GPM @ 30 PSI; accommodates  
one combination shower with  
eyewash or multiple eyewashes

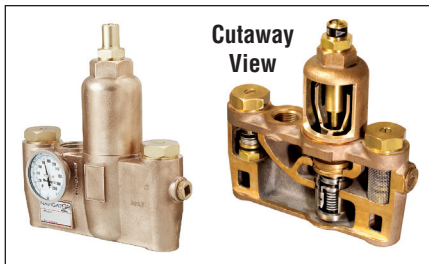

### □ S19-2200

67 GPM @ 30 PSI; accommodates  
up to two combination showers with  
eyewashes or multiple eyewashes



### □ S19-2300

103 GPM @ 30 PSI; accommodates  
up to three combination showers with  
eyewashes or multiple eyewashes

## Freeze and Scald Protection Valves

- **Freeze protection valves** completely open at 35°F (1.6°C) and closes at 45°F (7.2°C)
- **Scald protection valves** completely open at 105°F (40.5°C) and closes at 85°F (29.4°C)

☒ Combination units require both drench shower and eyewash protection valves.



### □ S45-1703

Freeze protection replacement valve for  
drench showers and eyewashes

### □ S45-1702

Scald protection replacement valve for  
drench showers and eyewashes

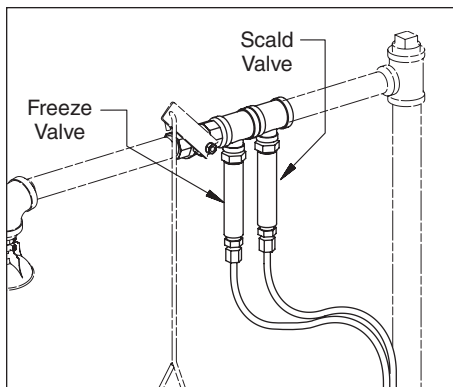

### □ S45-1987

Freeze protection kit for drench showers;  
includes freeze protection valve, tee,  
nipples, compression fitting, ball valve,  
tubing and cable tie

### □ S45-1990

Scald protection kit for drench showers;  
includes scald protection valve, tee,  
nipples, compression fitting, ball valve,  
tubing and cable tie

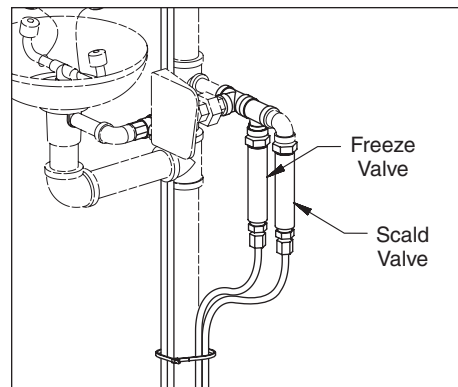

### □ S45-1986

Freeze protection kit for eyewashes; includes  
freeze protection valve, tee, nipples,  
compression fitting, ball valve, tubing and cable  
tie

### □ S45-1989

Scald protection kit for eyewashes includes  
scald protection valve, tee, nipples, compression  
fitting, ball valve, tubing and cable tie

### Flow Switch Alarm Systems

- Automatic, audible and visual alarm system
- Activates when unit is in use; preassembled
- Basic alarm meets NEMA 3 code (waterproof)
- Requires minimum of 2 GPM water flow to activate
- 1¼" NPT inlet piping

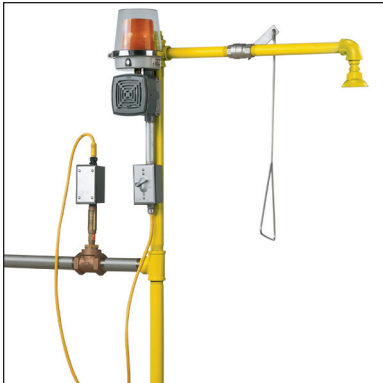

#### Standard Shower Alarms

- ☐ **S19-320**  
Shower/combination alarm with 6' cord (120 volt)
- ☐ **S19-320B**  
Shower/combination alarm with 6' cord and 120/24V AC transformer
- ☐ **S19-320C**  
Shower/combination alarm with 12' cord (120 volt)
- ☐ **S19-320E**  
Shower/combination alarm with 12' cord and 120/24V AC transformer

#### Standard Eyewash Alarms

- ☐ **S19-320A**  
½" NPT with 6' cord
- ☐ **S19-320D**  
½" NPT with 12' cord



#### Explosion-Proof Class 1 Division 1 Alarm Systems

- ☐ **S19-320EXP1A**  
Shower/combination alarm (120 volt) rated Class 1; Division 1; Groups C and D explosion proof
- ☐ **S19-320EXP1B**  
Shower/combination alarm (220 volt) rated Class 1; Division 1; Groups C and D explosion proof



#### Explosion-Proof Class 1 Division 2 Alarm Systems

- ☐ **S19-320EXP120**  
Shower/combination alarm (120 volt) rated Class 1; Division 2; Groups B, C, and D explosion proof
- ☐ **S19-320EXP220**  
Shower/combination alarm (220 volt) rated Class 1; Division 2; Groups B, C, and D explosion proof

### Retrofit Dust Covers



#### □ S45-1964

For use with any Bradley plastic eyewash bowl. Plastic bowl, dust cover, gasket and hardware



#### □ S45-2396

For use with any Bradley eyewash bowl. Stainless steel "clam shell" cover and bowl, stainless steel handle, tether and quick release pin

### Privacy Curtain



#### □ S19-330

- Provides privacy to shower user in emergency situations
- Universal mounting
- 3-ply, vinyl laminate, curtain reinforced at top and bottom
- Chemical and mildew resistant; waterproof
- High-visibility yellow color
- Dimensions: 70"L x 145"W
- Stainless steel, corrosion resistant curtain rail and mounting brackets
- Rail dimensions: 1½" x 42" diameter
- Not compatible with barrier-free, PVC and heat trace units – contact Bradley for more information

### Drench Shower Tester



#### □ S19-330ST

- Heavy-duty tester for required weekly activation
- Watertight funnel with weighted bottom
- 84" long with 8' telescoping aluminum handle
- Includes testing record card

### Heater Jacket Retrofit Kits for Portable Pressurized Eyewash Tanks



Thermostatically controls water in weather conditions down to -10°F (-23°C); uses standard 120 VAC. Tanks not included

#### □ S19-671HR (shown at right)

Heater jacket retrofit kit for 5-gallon tank

#### □ S19-690HR (shown at left)

Heater jacket retrofit kit for 10-gallon tank

#### □ S27-788HR (shown at center)

Heater jacket retrofit kit for 15-gallon tank

### Transport Cart for Pressurized Eyewash Tanks

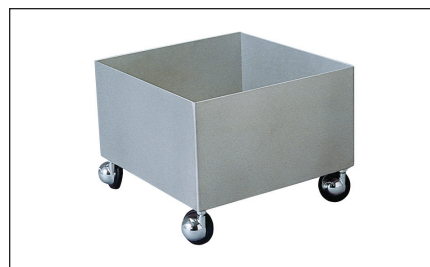

#### □ S19-690A

Four-wheel stainless steel transport cart. For use with eyewash tanks without heater jackets (eyewash tanks not included)