

ROOM - TO ROOM IN-WALL TRANSFER FAN

Model HT145

The HT 145 Transfer Fan is designed to transfer air from one room to another. Ideal for transferring hot air in the winter and cool air in the summer or even stale humid air in unventilated locations without sufficient air circulation

Ratings:
2.6 Sones- High Speed
1.5 Sones- Low Speed



C US

The housing is designed for easy installation and incorporates a variable speed control with minimum and maximum settings to obtain 55 to 145 C.F.M. Also included are two attractive white enamel two way deflection grilles.

- EASY INSTALLATION BETWEEN WALL STUDS OR CEILING JOISTS
- ADJUSTABLE DEPTH TO FIT WALLS 4" TO 5.5" THICK
- ATTRACTIVE WHITE ENAMEL TWO WAY DEFLECTION GRILLES
- VARIABLE SPEED ON-OFF SWITCH FOR GREATER AIR VOLUME CONTROL
- QUIET OPERATION EVEN AT MAXIMUM SPEED SETTING
- ENERGY EFFICIENT MOTOR
- 145 CUBIC FEET OF AIR AT MAXIMUM SPEED

FAN DIMENSIONS

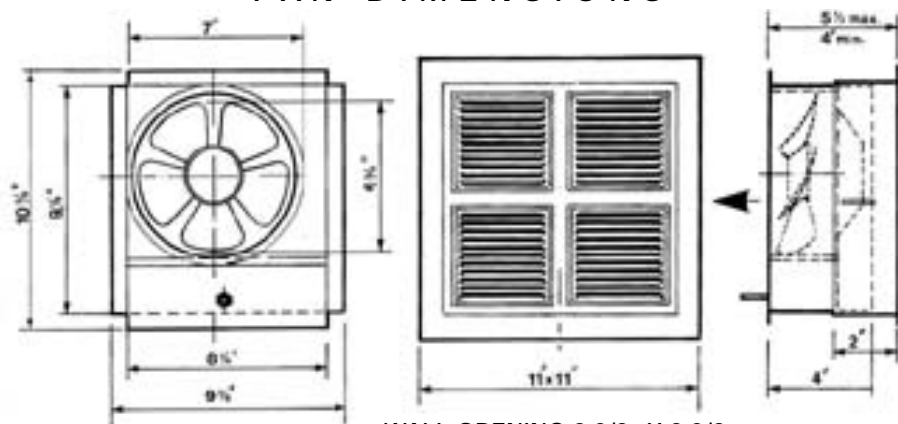

WALL OPENING 9 3/8" X 8 3/8"

TECHNICAL DATA

The housing is designed for easy installation and incorporates a variable speed control with minimum and maximum settings to obtain 55 to 145 C.F.M. Also included are two attractive white enamel two way deflection grilles.

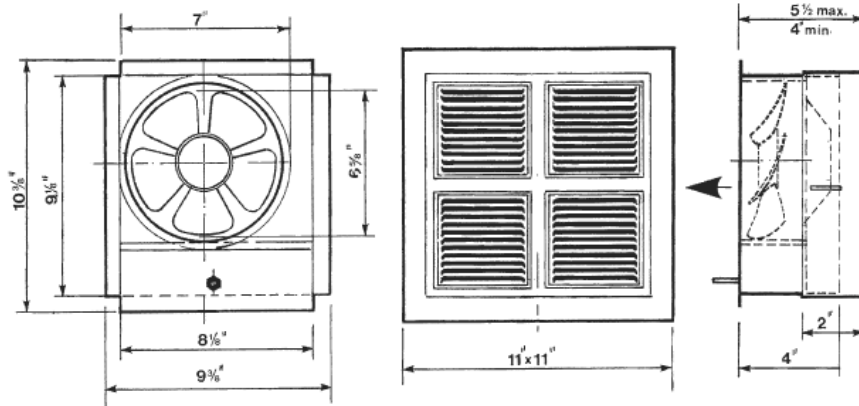

PARTS LIST

1. Speed Control Knob
2. Outlet Grille
3. 6-5/6" Plastic Fan Blade
4. Nut
5. Fan Housing
6. Side Selftapping Screw
7. Speed Control
8. Motor
9. Telescoping Sleeve
10. Inlet grille

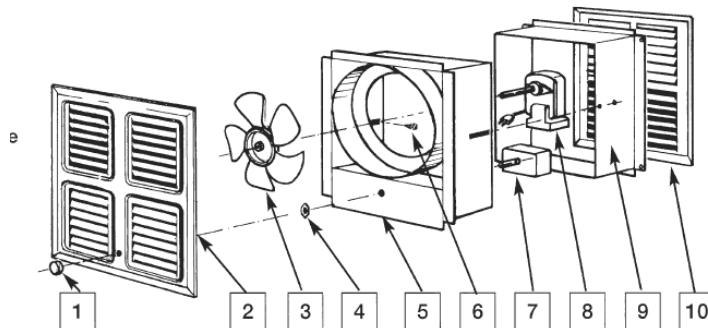

INSTALLATION INSTRUCTIONS

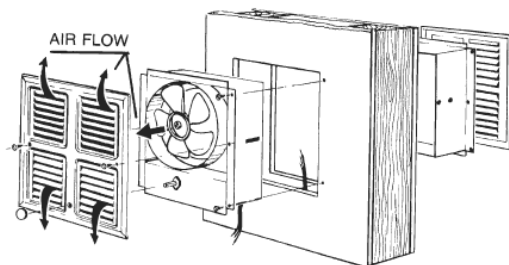

Cut a hole in the wall 8.5" x 9" using telescoping sleeve for the cutting in desired area of the wall between studs or ceiling joists.

Please Note: The HT145 FAN can be installed vertically or horizontally. Check air flow on diagram and turn the fan to acquire desired direction of air flow. Run 115/1/60 (normal house current) to the opening. The fan comes complete with an on-off variable speed controller. If the fan is within arms reach a second switch is not necessary.

Install the sleeve only, leaving the grille unattached for the moment. Secure the sleeve with 4 of the screws provided. Remove the electrical cover in the fan and

insert the wire. Use a connector on the outside of the electrical box. Connect the fan leads to the supply wire and replace the electrical cover. Install the HT145 FAN in place, joining the preinstalled sleeve. Once the fan and sleeve are in place, secure the flange of the fan with 4 screws and secure the fan to the sleeve with remaining 2 screws if necessary.

Install both grilles and your HT145 is ready to save you money.

SOUND RATING (AT HIGH SPPEED)

Model	OCTAVE BAND		1	2	3	4	5	6	7	8
	CENTER FREQ. HZ		63	125	250	500	1000	2000	4000	8000
HT-145	IN W.G.	0.00	62	55	56	57	55	47	49	50
	STATIC	0.19	60	55	54	54	52	44	46	47
	PRESSURE	0.41	62	55	52	50	46	41	43	50

RATING :

2.6 SONES - HIGH SPEED

1.5 SONES - LOW SPEED

THE SOUND POWER LEVEL RATINGS SHOWN ARE IN DECIBELS, REFERRED TO 10^{-12} WATTS CALCULATED PER AMCA STANDARD 301. VALUES SHOWN ARE FOR INLET L_{w} SOUND POWER LEVELS FOR INSTALLATION TYPE B: FREE INLET, DUCTED OUTLET. RATINGS DO NOT INCLUDE THE EFFECTS OF DUCT END CORRECTION.

CONTRACTOR		HT145 TRANSFER FAN DETAIL		
ARCHITECT	JOB	DATE	SUPERSEDES	DRAWING NO.
ENGINEER	DATE SUBMITTED	REVERSOMATIC Mfg. Ltd Toronto, Ontario		