

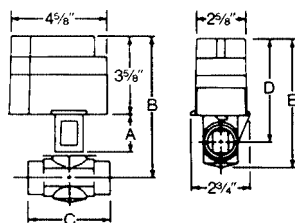

**1311-102**



VALVE SIZE	DIMENSIONS (inches)				
	A	B	C	D	E
3/4"	1 3/4	6 1/2	2 7/8	4 11/16	5 5/8
1"	1 15/16	6 3/4	3 1/8	4 13/16	5 7/8
1 1/4"	2 1/8	7 1/8	3 11/16	5	6 1/4

## HYDRONIC ZONE CONTROLS

Two Types of Valves, 2-Wire or 3-Wire, for Zoning Hydronic Systems up to 50 PSI

### FEATURES

- Quiet operation.
- Valve stem made of stainless steel.
- Automatic recycling manual operator shows valve position at all times.
- Built-in auxiliary contacts to control burner or circulator relay.
- Motor can be removed from valve assembly without draining system.

### SPECIFICATIONS

Electric rating of auxiliary switch . . . . . 2.0A at 24VAC

**CONTRACTOR TIP:** FOR HEAT/COOL APPLICATIONS, SEE 752-1 CONTROL ON PAGE 146.

DO NOT CHANGE VALVE ASSEMBLY WITHOUT DRAINING BOILER OR WHILE BOILER WATER IS HOT. FAILURE TO RELIEVE WATER PRESSURE OR WAIT UNTIL WATER COOLS COULD RESULT IN SCALDING INJURIES

### PARTS AND ACCESSORIES

See end of this section for additional parts and accessories

- F19-0097 — Motor assembly for 3-wire zone valves
- F19-0104 — Motor assembly for 2-wire zone valves
- F84-0433 — Valve assembly for 3/4" (both series)
- F84-0434 — Valve assembly for 1" (both series)
- F84-0435 — Valve assembly for 1 1/4" (both series)
- F92-0227 — Water seal kits for 3/4" (both series)
- F92-0228 — Water seal kits for 1" (both series)
- F92-0229 — Water seal kits for 1 1/4" (both series)
- F94-0775 — Valve body 3/4" (both series)
- F94-0777 — Valve body 1" (both series)
- F94-0779 — Valve body 1 1/4" (both series)

### TECHNICAL HELP

Zone Valve Troubleshooting . . . . . See pages 198-199

#### 3-WIRE, 24V VALVES WITH SCREW TERMINAL WIRING PANEL AND AUXILIARY SWITCH (SEE TABLE AT BOTTOM FOR COMPATIBLE THERMOSTATS)

Model Number	Tubing Size (I.D.)	24VAC Thermostat Circuit Rating	Time Cycle	Maximum Differential Across Valve	Maximum Water Temp.	Maximum System Pressure	Friction Loss Equivalents	
							Cv Factor	Ft. of Tubing
1311-102	3/4"	0.4A ①	Open: 45 seconds Close: 45 seconds	15 PSI	240°F (116°C)	50 PSI	23.5	2 1/2
1311-103	1"	0.4A ①	Open: 45 seconds Close: 45 seconds	15 PSI	240°F (116°C)	50 PSI	37.0	4
1311-104	1 1/4"	0.4A ①	Open: 45 seconds Close: 45 seconds	15 PSI	240°F (116°C)	50 PSI	42.2	7

#### 2-WIRE, 24V VALVES WITH SCREW TERMINAL WIRING PANEL AND AUXILIARY SWITCH

Model Number	Tubing Size (I.D.)	24VAC Thermostat Circuit Rating	Time Cycle	Maximum Differential Across Valve	Maximum Water Temp.	Maximum System Pressure	Friction Loss Equivalents	
							Cv Factor	Ft. of Tubing
1361-102	3/4"	0.2A ②	Open: 45 seconds Close: 60 seconds	15 PSI	240°F (116°C)	50 PSI	23.5	2 1/2
1361-103	1"	0.2A ②	Open: 45 seconds Close: 60 seconds	15 PSI	240°F (116°C)	50 PSI	37.0	4
1361-104	1 1/4"	0.2A ②	Open: 45 seconds Close: 60 seconds	15 PSI	240°F (116°C)	50 PSI	42.2	7

① Valve current is 0.4A only during opening or closing. For proper anticipation, select thermostat designed for use with a 3-wire zone valve.

② Valve current is 0.52A when opening but 0.2A when fully open: therefore set anticipator for 0.2A.

### 1311 COMPATIBLE THERMOSTATS TABLE

Model Number	Programming	Contacts	Profile	Terminals
1E35-910	Non-Programmable	Sealed Mercury Cell	Vertical	4, 5, 6
1F36-335	Non-Programmable	Sealed Mercury Cell	Horizontal	(O), 4, R5, Y6
1D35-602	Non-Programmable	Snap-Action	Horizontal	4, 5, 6
1F35-910	Non-Programmable	Sealed Mercury Cell	Horizontal	4, R5, Y6
1F90-371	5+2/5+1+1 Day Program	Electronic	Horizontal	RC, RH, W, Y, G, MV, O, B, 6
1F96-344	Non-Programmable	Electronic	Horizontal	RC, RH, W, Y, G, MV, O, B, 6
1F97-371	7-Day Program	Electronic	Horizontal	RC, RH, W, Y, G, MV, O, B, 6